

## ELS-2G

Project Name:

Type:



CASAMBI

## APPLICATION

The ELS is compact size LED strip with field adjustable wattage and color temperature. An Ideal for a size restricted architectural applications as well as for storage areas, displays, institutions, industrial and retail applications.

## FEATURES:

- Die-formed steel channel with knock-outs for versatile configuration and simple mounting.
- One continuous lens for 8-foot fixtures.
- All Steel surfaces are painted after fabrication with high gloss baked white matte powder paint.
- Frosted acrylic lens.
- Field adjustable wattage and color temperature.
- 8.0% uplight.
- Paint after fabrication.
- Sheet metal stamping.

## MOUNTING:

- Fixture is wall or surface mounted or pendant mounted, or suspended mounted with chains. (V-hook and chain kit is ordered separately)
- Compatible with most ceiling types.

## LED:

- Long-life, high-efficacy, micro-power LEDs.
- Color Rendering Index: > 80
- Field adjustable color temperature: 3500/4000/5000(K)
- Field adjustable wattage.
- Reported L70 (hours): >100,000

## ELECTRICAL:

- High power factor electronic driver, operate from a 120 ~ 277 Vac input range.
- Features included over surge protection.
- Power Factor: typical > 0.90, THD <20.
- Dimming Control: 0-10V 10%~100%.
- The dim-to-off voltage threshold of optional 12V AUX integrated driver ranges from 0.1V to 0.5V.
- Operating Temperature: -4°F (-20°C) ~ 122°F (50°C).
- <ELCU-200>
- Guarantees emergency lighting remains ON or is turned on when power to the control device is lost.
- Interfaces with fire alarm panel or security system.
- "Watchdog" feature allows emergency loads to be controlled in tandem with normal power loads.
- UL listed for use in emergency circuits.

## LISTING:

- UL listed and labeled.
- DLC listed.
- Suitable for damp locations.
- CEC Compliant EM (please contact for more information)
- 5 years warranty.
- ARRA compliant (optional).

## CONFIGURATIONS

	Size	LED Watts	Lumen Output	Color Temp.	Lumen Efficiency
ELS-2G	2FT	15W, 20W, 25W	1950lm, 2600lm, 3250lm	3500K	130 lm/W
	4FT	25W, 30W, 40W	3250lm, 3900lm, 5200lm		
	8FT	55W, 60W, 65W 65W, 75W, 91W	7150lm, 7800lm, 8450lm 8450lm, 9750lm, 11,830lm		
	2FT	15W, 20W, 25W	1965lm, 2620lm, 3275lm	4000K	131 lm/W
	4FT	25W, 30W, 40W	3275lm, 3930lm, 5240lm		
	8FT	55W, 60W, 65W 65W, 75W, 91W	7205lm, 7860lm, 8515lm 8515lm, 9825lm, 11,921lm		
	2FT	15W, 20W, 25W	1980lm, 2640lm, 3300lm	5000K	132 lm/W
	4FT	25W, 30W, 40W	3300lm, 3960lm, 5280lm		
	8FT	55W, 60W, 65W 65W, 75W, 91W	7260lm, 7920lm, 8580lm 8580lm, 9900lm, 12,012lm		

## ELS-2G

## ORDERING INFORMATION

EXAMPLE: ELS-2G-4-M3S-3T-UNV

MODEL	LENGTH		LED		COLOR TEMP.		VOLTAGE		MOUNTING	
ELS-2G	2	2' Length	M3S	15W /20W /25W LED	3T	Selectable 35/40/50K	UNV HV	120-277V 347-480V	(Blank) VH TB CHxx ACxx YCxx	Surface Mount V-Hook T-bar Clip Mounting Chain for use with V-hook (xx=length) Adjustable Aircraft Cable w/ Canopy (* xx = Specify length (48 or 96)) Adjustable Aircraft Y-cable with Toggles (* xx = Specify length in inches (60, 120, 180))
	4	4' Length	M3S	25W /30W /40W LED						
	8	8' Length	M3S H3S	55W /60W /65W LED 65W /75W /91W LED						

FINISH		PRESET		OPTIONS	
(Blank) *BK **CC *AMB	Semi-Glossy White (Std.) Black (RAL#9011) Custom Color <sup>3</sup> Anti-Microbial Coating (Matte Skye White)  * Non-standard finish with extra charge. ** CC: additional charge & set up fee. Provide RAL# code.	(Blank) PS(Lxx,yyK)	Non-Preset Preset Request; XX for watt, YY for CCT  *Factory default setting: 2FT: 25W, 40K 4FT: 40W, 40K 8FT: 65W, 40K 91W, 40K	EMG8 EMG15 EMG20 EMG25 ELCU-200 WG AMB LOS-502S  ANT-3C RC-100 EFS01RE  ARRA COUP	1296 LUMEN EM Battery Backup (CEC Compliant EM) <sup>1</sup> 2430 LUMEN EM Battery Backup (CEC Compliant EM) <sup>1</sup> 3240 LUMEN EM Battery Backup (CEC Compliant EM) <sup>1</sup> 4050 LUMEN EM Battery Backup (CEC Compliant EM) <sup>1</sup> Fail-to-on Emergency lighting, UL924 <sup>2</sup> Wire Guard Anti-Microbial Coating (Matte Skye White) Fixture external mount, PIR Occupancy Sensor, no dimming support, 120/277V with standard cone shape lens (15ft) with 1.18" extension joint. Adjustable through a dip switch. Microwave bi-level Occupancy Sensor <sup>4,5</sup> Remote control for ANT-3C sensor Fixture external mount, PIR Occupancy Sensor, Dimming, Day Light Harvesting and Bi-Level support. 120-277V with lens and extension joint. Assembled in USA for Buy American Act Linkable Coupling

LIGHTING CONTROL SYSTEM	
PPA102S	<Bluetooth> Bluetooth Powerpack (Consult factory for installation location)
CASAMBI	Contact factory for CASAMBI READY options

## NOTES:

- Contact factory for other emergency ballast options.
- Shipped separately.
- Refer to color charts (RAL and/or Cardinal) in the separate attachment.
- See Table2 to find factory setting.
- Detection radius / angle: max. 12FT (4M) / 360 degree.  
Detection height: max. 12FT (4M).

## COMPATIBLE DIMMER SWITCH (TABLE 1)

Model #	Brand	Compatible Dimmer Switch	
(Blank)	-	<Lutron>	Maestro MS-Z101, Nova NTSTV, Diva DVSTV
		<Philips>	Sunrise SR1200ZTUNV

## ANT-3C FACTORY SETTING (TABLE 2)

Detection Area	100%
Hold-time	5 min.
Daylight sensor	On
Dimming level	30%
Dimming time	∞

\* See a separate attachment to find more information.

# ELS-2G

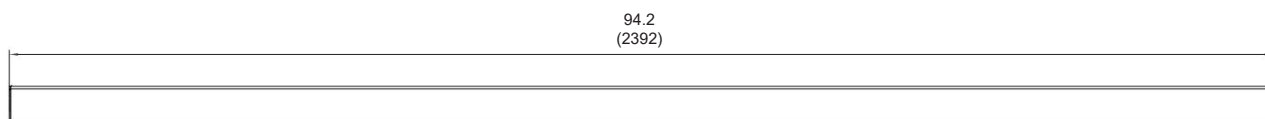
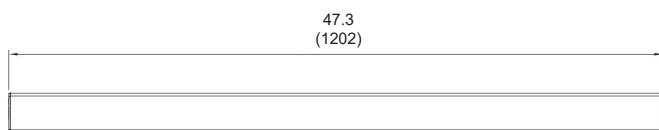
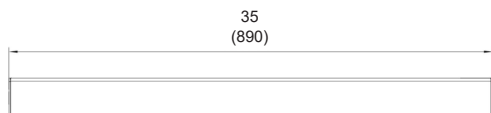
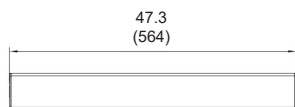

All dimensions are in inches (millimeters).

