

# LAD8C

Project Name:	
Type:	



**APPLICATION**

8" Horizontal commercial frame-in is non-insulated ceiling design for high wattage application with lens. Ideal for medium to high ceilings for commercial installations.

**FEATURES:**

- Galvanized steel plaster frame: Quality galvanized steel ring riveted to elevated steel junction box tray.
- Housing can be removed from plaster frame for junction box access.
- Mounting: Bar hanger allows fixtures to affix to T-bar grid into wood or steel joist members.
- 16-gauge galvanized steel construction.
- Maximum 1-1/2" ceiling thickness.
- Toolless adjustments post installation.
- Unique optic allows high lumen transmission while concealing the LED light source resulting in efficient, inviting light and minimizing LED glare.
- Non-insulated ceilings or where insulation can be kept 3" from all side of housing.

**JUNCTION BOX:**

- Galvanized steel junction box with seven 1/2" knockouts, four pryouts, and snap on cover.
- Electrical connections are made through a single junction box door.
- Access to junction box from below ceiling after removal of reflector for easy maintenance.

**BAR HANGERS:**

- Pre-installed adjustable bar hangers for span 24".
- No clips required. Secure bar hanger to T-bars with wires or screws.
- Integral captive nails included for fast and easy installation.

**LED:**

- CREE LED technology.
- 50,000 hours.
- 4000K color temperature standard.
- 16W, 25W, 38W, 50W, 70W, 100W LED.
- Color Rendering Index: > 90
- Projected L70 hours: 60,000
- NEMA ANSLG C78.377

**ELECTRICAL:**

- Input voltage: 120-277V
- 0-10V (dim to 1%, 120-277V)
- Operating Temperature: -4°F (-20°C) ~ 104°F (40°C)
- Thermal protection.
- Surge protection (3kV line to line, 6kV line to earth).
- Protections: Output open load, over-current and short-circuit(hiccup), and over-temperature with auto recovery.
- Conducted and radiated EMI: Compliant with FCC CFR Title 47 Part 15 Class B (120 Vac)/ Class A (277 Vac) and EN55015 (CISPR 15) at 220/230/240 Vac.
- <ELCU-200>
- Guarantees emergency lighting remains ON or is turned on when power to the control device is lost.
- Interfaces with fire alarm panel or security system.
- "Watchdog" feature allows emergency loads to be controlled in tandem with normal power loads.
- UL listed for use in emergency circuits.

**LISTING:**

- ROHS.
- UL/CUL listed for damp locations with covered ceiling.
- UL/CUL wet location listed with "W" lens only.
- Listed to UL 1598 and UL 8750.
- Minimum 75°C supply conductors.
- CSA certified to US.
- Energy Star certified. <sup>5</sup>
- 5 years limited warranty.
- 10 years limited warranty (optional). <sup>8,9</sup>
- ARRA compliant (optional).
- BAA compliant (optional).
- BABA compliant (optional).

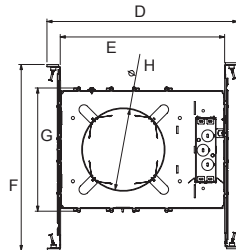

**Dimensions**

- D: 15-5/16" (389.2)
- E: 12-19/32" (320)
- F: 16-1/8" (410)
- G: 9-7/16" (240)
- H: 8-1/4" Dia. (209.5)

All dimensions are in inches. Drawings are for dimensional detail information only.

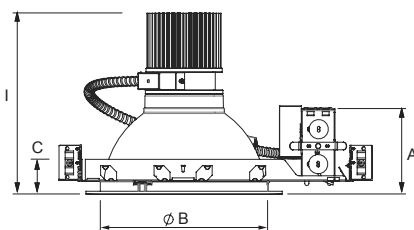

**Dimensions (16W, 25W, 38W, 50W)**

- A: 3-15/16" (100.6)
- B: 8-5/16" Dia. (211)
- C: 1-1/2" (38)
- I: 8-1/2" (214.9)

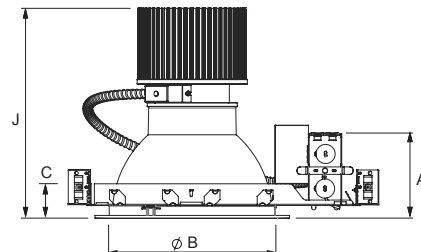

**Dimensions (70W, 100W)**

- A: 3-15/16" (100.6)
- B: 8-5/16" Dia. (211)
- C: 1-1/2" (38)
- J: 9-15/16" (251.9)

# 8" COMMERCIAL NEW CONSTRUCTION FRAME

## ORDERING INFORMATION

EXAMPLE: LAD8C-25L-40K-UNV-DM-WW-O60

MODEL		LED				COLOR TEMP.		VOLTAGE		LED DRIVER	
LAD8C	8" Commercial Frame	<b>16L</b> 16W LED <b>25L</b> 25W LED <b>38L</b> 38W LED <b>50L</b> 50W LED <b>70L</b> 70W LED <b>100L</b> 100W LED <b>107L</b> 107W LED  <b>xx</b> Custom lumen or Watt: ____ LM or ____ W ** Max up to 8550lm or 107W * with TDM/ELV: offered to closest lm or W.	<u>Lumen Output</u>	<u>Lumen Efficiency</u>	<b>-27K</b> 2700K <b>-30K</b> 3000K <b>-35K</b> 3500K <b>-40K</b> 4000K (Std.) <b>-50K</b> 5000K <b>-275K</b> Tunable white 2700-5000K (Max. 50W) <sup>3</sup>	<b>UNV</b> 120-277V <b>347</b> 347V <sup>4</sup>	<b>DM</b> 0-10V(dim to 1%, 120-277V) <b>TDM</b> Triac Dim. (120V only) <b>ELV</b> ELV compatible (reverse-phase or trailing-edge), (120V only)  <b>LDE1</b> 1%, Lutron (Soft Fade to Black, Ecosystem) <sup>2</sup> <b>MU050</b> 0-10V dim to 1% for -275K (Tunable White) <b>ED560</b> eldoLED LightShape DALI dim to dark, 0.1% ~ 100%  <b>RDMX</b> eldoLED POWERdrive DMX/RDM Full-color, 0.1% ~ 100%  <b>SDXX</b> XX% / 100% Bi-Level Step dim (Specify XX: 10%~70%) <sup>12</sup>  <b>-GM</b> NEMA SSL 1, UL 8750 Class 1 or 2, 2kV Surge Protection, NEMA C82.77.10, driver integral thermal protection, TITLE 47 CFR 15, Class A sound rated <sup>14</sup>				
			1577.6 lm	98.6 lm/W							
			2490 lm	99.6 lm/W							
			4006.8 lm	101.96 lm/W							
			4602 lm	98.7 lm/W							
			6874 lm	98.2 lm/W							
			8550 lm	85.5lm/W							
			7830 lm	73.2 lm/W							

EM <sup>9, 10, 13</sup>		REFLECTOR		TRIM RING		LENS		OPTIC	
<b>EMI8</b>	1296 LUMEN EM Battery Backup	<b>WW</b>	White Reflector w/ White Plastic Ring	<b>(Blank)</b>	White Trim Ring	<b>(Blank)</b>	Dry / Damp location	<b>O20</b>	Narrow
<b>EMI15</b>	2430 LUMEN EM Battery Backup	<b>CW</b>	Clear Reflector w/ White Plastic Ring	<b>BK</b>	Black Trim Ring	<b>W</b>	White Smooth Splay w/ Frosted Lens (Wet Location) <sup>11</sup>	<b>O40</b>	Medium
<b>EMI25 INT</b>	4050 LUMEN EM Battery Backup EM Pilot Located on Reflector	<b>PLW</b>	Platinum Haze Reflector w/ White Plastic Ring					<b>O60</b>	Wide (Std.)
								<b>WA</b>	Wall Wash

OPTIONS		LIGHTING CONTROL SYSTEM	
<b>ARRA</b>	Assembled in USA	<b>VRF</b>	<Lutron Vive System Enabled> Vive Integral fixture control (RF only, for Lutron EcoSystem drivers)
<b>BAA</b>	BAA(Buy American Act) compliant	<b>FCJS0</b>	FCJS-010, Vive Attached fixture control (RF only for 0-10V drivers)
<b>ELCU-200</b>	Fail-to-on Emergency lighting, UL924 <sup>1</sup>	<b>FCJSE</b>	FCJS-ECO, Vive Attached fixture control (RF only for Lutron EcoSystem drivers)
<b>GTD</b>	Bodine Generator Transfer Device	<b>FCJS0EM</b>	FCJS-010-EM, UL 924 Emergency (Must be ordered with FCJS-010)
<b>GTD10DIM</b>	Bodine Generator Transfer Device (0-10VDC Dimmer Override) Rough-in frame pre-ship request <sup>6</sup>	<b>FCJSEEM</b>	FCJS-ECO-EM, UL 924 Emergency (Must be ordered with FCJS-ECO)
<b>FRAME</b>	Optional 10 Years Limited Warranty <sup>7,8</sup>		
<b>O10W</b>	Self-flanged trim	<b>PPA102S</b>	<Bluetooth> Bluetooth Powerpack (Consult factory for installation location)

**NOTES:**

- Shipped separately.
- Available with 16L, 25L and 38L only.
- Must be ordered with ED560 or MU050 driver.
- Only available up to 38W.
- 38L model is exempt.
- LED driver and EM (if selected) will be included.
- This limited warranty covers electrical parts only and does not apply to labor, equipment lease, or defect from improper installation or operation.
- Available with 0-10V dimming only. (Up to 50W).
- Contact the factory for other emergency battery backup options.
- Must specify voltage, not available with 347V.
- There is a 33% lumen decrease.
- Provided with a remote driver box.
- EMI15 can't be used with 11L or lower wattage, and EMI25 can't be used with 16L or lower wattage.
- Contact the factory to check for a qualifying LED driver.

### COMPATIBLE DIMMER SWITCH (TABLE 1)

Model #	Brand	Compatible Dimmer Switch	
DM (0-10V, dim to 1%)	-	<Leviton>	IlumaTech series (IP710-DL)
		<Lutron>	Nova series (NFTV-xx), Diva series (DVTV-xx)
DM (120Vac for Triac, ELV)	-	<Lutron>	S-603PG, DVCL-153P, DV-600P, TGCL-153P, S600P,DVELV-303P, SELV-300P, TG-600P, LG-600P, CT-103P, MAELV-600, FAELV-500
		<Leviton>	IPI06-1LZ, 6631-2, VPE06, 6683-IW, 6161, 6633-P, IPE04
		<Cooper>	DLC03P, SLC03P, DAL06P
		<Lightolier>	ZP260QEW
ED560	eldoLED DUALdrive	<Lunatone>	SS-LUNAT PS2 30mA SS-LUNAT Touch or BT SS-LUNAT Comm
LDE1	Lutron Hi-lume 1% EcoSystem	<Lutron>	PowPak Dimming Modules: RMJ-ECO32-DV-B, FCJ/FCJS-ECO Energi Savr Node (120V only): QSN-1ECO-S, QSN-2ECO-S GRAFIK Eye QS/Homeworks QS control unit (120V only): QSGRJ- E(wireless) QSGR- E Quantum Hub (120V only): QP2- _2C/4C/6C/8C Homeworks QS/myRoom Plus power module (120V only): LQSE-2ECO-D



