

SBW-2G LED INSTALLATION INSTRUCTIONS



BEFORE YOU BEGIN

Read and follow all safety instructions



WARNING

RISK OF FIRE, EXPLOSION AND ELECTRIC SHOCK

- This product should be installed, inspected, and maintained by a qualified electrician only, in accordance with the NEC (National Electric Code) and all local codes.
- Turn off electrical power before inspection, installation or removal.
- Use only UL (or other NRTL) approved wire for input/output connections.
- Make sure LEDs and drivers are cool to touch when performing maintenance.
Make sure the supply voltage is the same as the rated voltage of the luminaire.
- Do not install in a hazardous atmosphere, except where the ambient temperature does not exceed the rated operating temperature of the fixture.
- Keep tightly closed when in operation



Prepare Electrical Wiring



Electrical Requirements

Must check if the local voltage range is correspond with the working voltage of the fixture. Use min. 75°C supply.



Grounding Instructions

The grounding and bonding of the overall system shall be done in accordance with NEC Article 600 and local codes.



Follow all applicable safety procedures and use Personal Protective Equipment such as hardhats, safety glasses, reflective vest, electrical safety gloves, fall protection equipment and safety toe boots during the installation, operation, and maintenance of the luminaire.

*** Any damage caused from improper installation will void warranty and not be accepted for RGA (Return Goods Authorization). Improper installation includes but not limited to field-drilled hole(s), improper latch closure and any damage caused during installation.**

Contractor is responsible for adequately reinforcing ceilings to support luminaire weight. Utopia Lighting accepts no responsibility for inadequately reinforced ceilings. The information contained in this drawing is the sole property of Utopia Lighting.

Any reproduction in part or whole without the written permission of Utopia Lighting is prohibited and warranty is voided.



SBW-2G LED INSTALLATION INSTRUCTIONS

Surface Wall Mount - 12", 18", 24" size

IMPORTANT

1. Read all instructions.
2. Please install in accordance with national and local electrical code regulations.
3. This product is intended to be installed and serviced by a qualified, licensed electrician.
4. No wet locations! Dry and damp location only.
5. Turn off electrical power before installing or servicing fixture.
6. To reduce the risk fire and overheating, make sure all connections are tight.
7. Under no circumstances can the lighting fixture be covered with heat insulation gasket or similar materials.

ACCESSORY



Wire Nut



Anchor



Screw
PA4X30

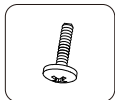

Screw
CM4X12

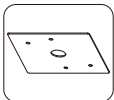

Square
Plate



Please isolate two dimming wires by P2 terminal individually if no need dimming;
MUST connect wires with corresponding colors as shown.



SHOCK HAZARD!
May result in serious injury or death.
Turn power OFF at circuit breaker prior to installation or servicing.

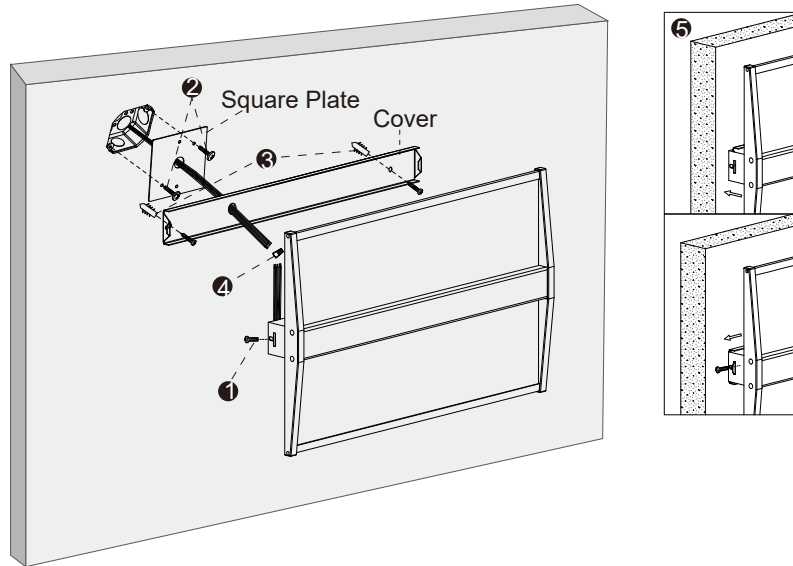

- 1 Take off the cover of driver box by screwdriver.
- 2 Thread the power cord of junction box into the cover of driver box and square plate, fix the cover of square plate into the junction box with screws, then plaster.
- 3 Fix the driver box cover on the wall with screw.
- 4 Make wiring connections with junction box by the wiring caps, then hide all the wires inside the junction box.
- 5 Fix the luminaire on the cover of driver box with screws as shown.

WIRING

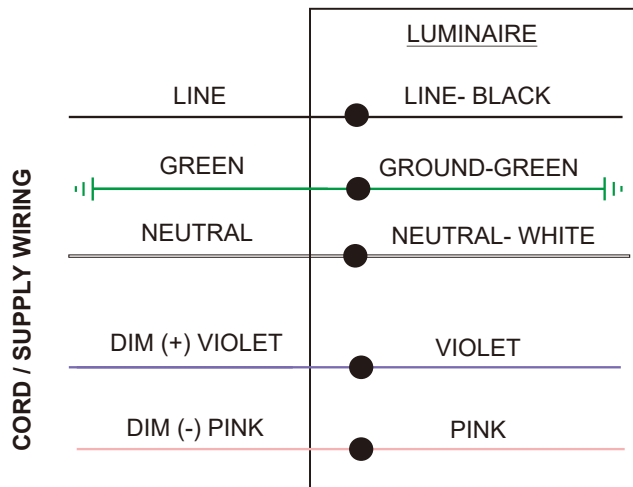

SBW-2G LED INSTALLATION INSTRUCTIONS

Surface Ceiling Mount - 12", 18", 24" size

IMPORTANT

1. Read all instructions.
2. Please install in accordance with national and local electrical code regulations.
3. This product is intended to be installed and serviced by a qualified, licensed electrician.
4. No wet locations! Dry and damp location only.
5. Turn off electrical power before installing or servicing fixture.
6. To reduce the risk fire and overheating, make sure all connections are tight.
7. Under no circumstances can the lighting fixture be covered with heat insulation gasket or similar materials.

ACCESSORY



Wire Nut



Anchor



Screw
PA4X30

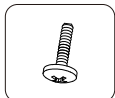

Screw
CM4X12

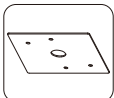

Square
Plate



Butterfly
Drywall Anchor



Please isolate two dimming wires by P2 terminal individually if no need dimming;
MUST connect wires with corresponding colors as shown.



SHOCK HAZARD!
May result in serious injury or death.
Turn power OFF at circuit breaker prior to installation or servicing.

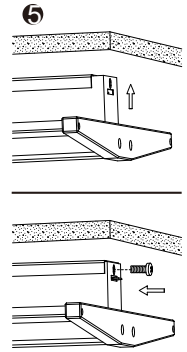
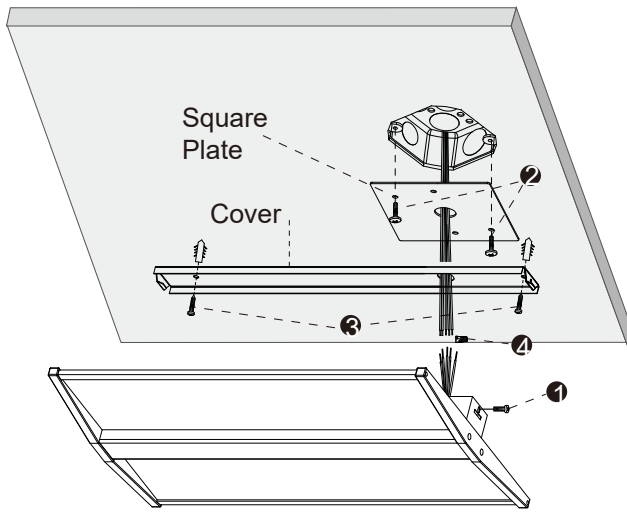

- 1 Take off the cover of driver box by screwdriver.
- 2 Thread the power cord of junction box into the cover of driver box and square plate, fix the cover of square plate into the junction box with screws, then plaster.

- 3 Fix the driver box cover on the wall with screw.

Ceiling Type

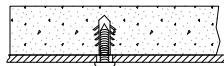

Hole Diameter: 0.20"

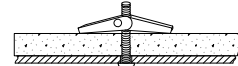

Hole Diameter: 0.47"

- 4 Make wiring connections with junction box by the wiring caps, then hide all the wires inside the junction box.
- 5 Fix the luminaire on the cover of driver box with screws as shown.

CORD / SUPPLY WIRING		LUMINAIRE	
LINE		●	LINE- BLACK
GREEN		●	GROUND-GREEN
NEUTRAL		●	NEUTRAL- WHITE
DIM (+) VIOLET		●	VIOLET
DIM (-) PINK		●	PINK

