

## DW-LP LED

Project Name:	
Type:	



CASAMBI

## APPLICATION

LED premium grade enclosed and gasket fixture. For use in both indoor and outdoor applications where dust and moisture resistance and other non-hazardous contaminants. It is often used in refrigerated areas, food processing facilities, kitchens, parking garages, car washes, schools, government facilities, public areas and industrial spaces with low to medium mounting heights.

## FEATURES:

- Low profile designed weatherproof enclosure, one-piece 5VA fiberglass housing, NEMA 4X gasket.
- Impact Resistant Acrylic and Polycarbonate lenses available.
- The diffuser and upper components are locked into place by retaining latches, assuring a secure and tight seal.
- Captive non-metallic snap-action latch cam secures lens to housing. Optional stainless steel latch.
- White end plugs 1/2" Housing end holes (2) - Snaps and locks tight to maintain tight seal of unused end holes.
- Smooth edges for easy handling.
- Tamper resistant (TR) option prevents the lens from being removed by unauthorized personnel. Tamper proof driver cat. TRDT required (sold separately).

## MOUNTING:

- Surface mount bracket provided as a standard (Stainless steel).
- Chain/cable, stem (single or double), 45 degree mount optional.

## LED:

- Color Temperature: 2700/3000/3500/4000/5000 (K).
- LED Module: High efficiency up to 162 LPW.
- Calculated L70: 122,000 hours
- Reported L70: +60,000 hours
- Poke in wire connectors.
- Color Rendering Index: 80+ (optional >90).

## ELECTRICAL:

- High power factor electronic driver, operate from a 120~277 Vac input range, 50 / 60 Hz.
- Generic: 0-10V Dim to 10%(GR).
- Power Factor: +0.9
- Efficiency: +85%
- Ambient Operating Temperature:
  - 22°F (-30°C) ~ 122°F (50°C) (Std.)
  - 40°F (-40°C) ~ 122°F (50°C) (with LT option)
  - 31°F (-35°C) ~ 140°F (60°C) (with HT option)
- Constant Current, Class 2
- <ELCU-200>
- Guarantees emergency lighting remains ON or is turned on when power to the control device is lost.
- Interfaces with fire alarm panel or security system.
- "Watchdog" feature allows emergency loads to be controlled in tandem with normal power loads.
- UL listed for use in emergency circuits.

## LISTING:

- ROHS.
- UL/CUL listed and labeled.
- Listed to UL 1598 and UL 8750.
- DLC listed. <sup>12</sup>
- Suitable for damp / wet location listed.
- IP Rating: IP65, IP66, and IP67.
- CEC Compliant EM (please contact for more information)
- Made in USA.
- ARRA and BAA compliant.
- 5 years limited warranty.
- NSF International certified.
- NSF Splash Zone 1 & 2 rated.
- U.S. Department of Agriculture.
- Canadian Standard Association.
- Nema 4X rated lens and housing.
- 1500 PSI hose-down.
- Bluetooth Mesh System available, please contact factory for more information.

## DW-LP LED

## CONFIGURATIONS (DIRA Lens)

	Model #	AC Input	Lumen Output	Lumen Efficiency
2FT	18LED	18W	2548 lm	141.5 lm/W
	20LED	20W	2831 lm	
	27LED	27W	3823 lm	
	36LED	36W	5097 lm	
4FT	18LED	18W	2548 lm	
	27LED	27W	3823 lm	
	36LED	36W	5097 lm	
	45LED	45W	6372 lm	
	56LED	56W	7930 lm	
	72LED	72W	10196 lm	
8FT	100LED	100W	14150 lm	
	36LED	36W	5097 lm	
	54LED	54W	7646 lm	
	72LED	72W	10196 lm	
	88LED	88W	12462 lm	
	112LED	112W	15861 lm	
	144LED	144W	20376 lm	
	170LED	170W	24055 lm	

: Based on 5000K.

## CONFIGURATIONS (DIRAFR Lens)

	Model #	AC Input	Lumen Output	Lumen Efficiency
2FT	18LED	18W	2409 lm	133.8 lm/W
	20LED	20W	2677 lm	
	27LED	27W	3613 lm	
	36LED	36W	4819 lm	
4FT	18LED	18W	2409 lm	
	27LED	22W	3613 lm	
	36LED	36W	4819 lm	
	45LED	45W	6023 lm	
	56LED	56W	7496 lm	
	72LED	72W	9638 lm	
8FT	100LED	100W	13380 lm	
	36LED	36W	4819 lm	
	54LED	54W	7228 lm	
	72LED	72W	9638 lm	
	88LED	88W	11780 lm	
	112LED	112W	14993 lm	
	144LED	144W	19267 lm	
	170LED	170W	22746 lm	

: Based on 3500K.

## CONFIGURATIONS (W Distribution)

	Model #	AC Input	Lumen Output	Lumen Efficiency
2FT	18LED	18W	2288 lm	127 lm/W
	20LED	20W	2543 lm	
	27LED	27W	3433 lm	
	36LED	36W	4577 lm	
4FT	18LED	18W	2288 lm	
	27LED	22W	3433 lm	
	36LED	36W	4577 lm	
	45LED	45W	5721 lm	
	56LED	56W	7121 lm	
	72LED	72W	9156 lm	
8FT	100LED	100W	12700 lm	
	36LED	36W	4577 lm	
	54LED	54W	6865 lm	
	72LED	72W	9156 lm	
	88LED	88W	11191 lm	
	112LED	112W	14240 lm	
	144LED	144W	18288 lm	
	170LED	170W	21590 lm	

: Based on 4000K.

## CONFIGURATIONS (PG Distribution)

	Model #	AC Input	Lumen Output	Lumen Efficiency
2FT	18LED	18W	2141 lm	118.9 lm/W
	20LED	20W	2379 lm	
	27LED	27W	3212 lm	
	36LED	36W	4282 lm	
4FT	18LED	18W	2141 lm	
	27LED	22W	3212 lm	
	36LED	36W	4282 lm	
	45LED	45W	5721 lm	
	56LED	56W	7121 lm	
	72LED	72W	8565 lm	
8FT	100LED	100W	11890 lm	
	36LED	36W	4282 lm	
	54LED	54W	6421 lm	
	72LED	72W	8565 lm	
	88LED	88W	10470 lm	
	112LED	112W	13325 lm	
	144LED	144W	17121 lm	
	170LED	170W	20213 lm	

: Based on 4000K.

## DW-LP LED

## ORDERING INFORMATION

EXAMPLE: DW-LP-4-45LED-50K-HE-UNV-PIRA

MODEL	LENGTH		LED		COLOR TEMP.		EFFICACY		CRI		VOLTAGE										
DW-LP	2	2' Length	18LED	18W LED	-27K	2700K	HE	High Efficacy (Std.)		(Blank)	80+ CRI	UNV	120-277V								
			20LED	20W LED										-30K	3000K						
			27LED	27W LED												-35K	3500K				
			36LED	36W LED														-40K	4000K		
	4	4' Length	18LED	18W LED																-50K	5000K
			27LED	27W LED																	
			36LED	36W LED																	
			45LED	45W LED																	
			56LED	56W LED																	
			72LED	72W LED																	
	8	8' Length	100LED	100W LED																	
			36LED	36W LED																	
			54LED	54W LED																	
			72LED	72W LED																	
			88LED	88W LED																	
			112LED	112W LED																	
			144LED	144W LED																	
			170LED	170W LED																	

\* Contact factory for custom wattage or lumen requirement.

\* Contact factory for custom wattage or lumen requirement.

DIFFUSER <sup>8</sup>		LED DRIVER		DISTRIBUTION	
<b>PIRA</b> Polycarbonate, Linear Ribbed Clear Lens <b>PIRAFR</b> Polycarbonate, Linear Ribbed Frosted Lens <b>DIRA</b> Impact resistant acrylic, Linear Ribbed Clear Lens (Std.) <b>DIRAFR</b> Impact resistant acrylic, Linear Ribbed Frosted Lens <b>PCC</b> Polycarbonate smooth clear lens <b>PCF</b> Polycarbonate smooth frosted lens <b>IAC</b> Impact resistant acrylic, smooth clear lens <b>IAF</b> Impact resistant acrylic, smooth frosted lens <b>IACD</b> Deep impact resistant acrylic clear lens <b>IAFD</b> Deep impact resistant acrylic frosted lens <b>NPIRA</b> Polycarbonate, Narrow Linear Ribbed Clear Lens <b>NPIRAFR</b> Polycarbonate, Narrow Linear Ribbed Frosted Lens <b>NDIRA</b> Impact resistant acrylic, Narrow Linear Ribbed Clear Lens (Std.) <b>NDIRAFR</b> Impact resistant acrylic, Narrow Linear Ribbed Frosted Lens <b>NPCC</b> Polycarbonate, Narrow smooth clear lens <b>NPFC</b> Polycarbonate, Narrow smooth frosted lens <b>NIAAC</b> Impact resistant acrylic, Narrow smooth clear lens <b>NIAF</b> Impact resistant acrylic, Narrow smooth frosted lens		<b>GR</b> Generic, 0-10V 10% dim (Std.) <sup>3</sup> <b>DM1</b> Generic 0-10V 1% dim <b>SD40</b> 40% / 100% Bi-Level Step dim <b>SDXX</b> XX% / 100% Bi-Level Step dim (Specify XX : 10% ~ 70%) <b>TD30/70</b> 30% / 70% / 100% Tri-Level Step dim <b>TDXX/YY</b> XX% / YY% / 100% Tri-Level Step dim (Specify XX, YY : 10% ~ 70%) <b>ES566</b> eldoLED SOLOdrive Natural Dimming to dark, 0-10V, 100% ~ 0.1% dim <b>LDE1</b> Hi-lume 1% EcoSystem LED driver with Soft-on, Fade-to-Black dimming technology, 100% ~ 1% dim		<b>(Blank)</b> Normal <b>W</b> Wide <b>PG</b> Parking Garage	<small>* W and PG distribution: only available with IACD or IAFD lens option.</small>
		 <b>BLT</b> Bluetooth Mesh System (contact factory for more information)			

## DW-LP LED

MOUNTING		OPTIONS				
(Blank)	Surface Mount (Stainless steel)	EMG8	1296 LUMEN EM Battery Backup (CEC Compliant EM) <sup>1,2</sup>	WMS	Wet Location Occupancy Sensor	
45D	45 Degree Mount (Stainless steel) <sup>11</sup>	EMG15	2430 LUMEN EM Battery Backup (CEC Compliant EM) <sup>1,2</sup>	WDMS	Wet Location Day Light Motion Sensor,	
SP	1/2" IP single stem mounting bracket for 2ft fixture only (stem purchased separately) <sup>13</sup>	EMG20	3240 LUMEN EM Battery Backup (CEC Compliant EM) <sup>1,2</sup>	LRD-509S-x	Fail on	
DP	3/8" double threaded rod mounting bracket (threaded rod by others)	EMG25	4050 LUMEN EM Battery Backup (CEC Compliant EM) <sup>1,2</sup>		Fixture external mount 0-10V SmartDIM or multi-level high/low dim control occupancy sensor, Fail on ("IR remote programmable), (See note 7 to select lens for "x") <sup>6,9</sup>	
DP2	1/2" IP double stem mounting bracket (stem purchased separately)	CWEM6	6W EM Cold Weather -4°F (-20°C) ~ 131°F (55°C)			
	Chain or Cable	ELCU-200	Fail-to-on Emergency lighting, UL924 <sup>5</sup>	LMS-109	Microwave Occupancy/Ambient Light Sensor	
CCP	Topaz 34S Swivel stem hanger (order with SH-1/2-xx)	GTD	Bodine Generator Transfer Device		LT	Low Temperature for freezer (-40°F (-40°C) ~ 122°F (50°C))
34S	1/2" IPS Stem with canopy kits for SP option (xx=stem length, 18, 24, 36, 48 inches)	GTD10DIM	Bodine Generator Transfer Device (0-10VDC Dimmer Override)		HT	High Temperature (-31°F (-35°C) ~ 140°F (60°C))
		GLR	Fast Blow Fuse <sup>1</sup>	AMB	Anti-Microbial Coating (Matte Skye White)	
		GMF	Slow Blow Fuse <sup>1</sup>	HC403	Microwave bi-level Occupancy Sensor, adjustable via DIP switch <sup>10</sup>	
		SSL	316 Stainless Steel Latch	HRC-05 EFS01RE	Handheld Remote for HC403v	
		TRCP	Tamper-proof plastic latch		Fixture External mount 0-10V Bi-Level Dimming Occupancy PIR Sensor. Daylight Harvesting. (adjustable by Remote Control only-RM51)	
		TRDT	Tamper-proof Driver Tool			
		DC011	One end 1/2" Hub. Water Tight Die Cast Fitting	RM5	Handheld Remote for EFS01RE	
		DC012	Both ends 1/2" Hub. Water Tight Die Cast Fitting			
		DC021	One end 3/4" Hub. Water Tight Die Cast Fitting			
		DC022	Both ends 3/4" Hub. Water Tight Die Cast Fitting			

LIGHTING CONTROL SYSTEM	
<b>PPA102S</b>	<Bluetooth> Bluetooth Powerpack (Consult factory for installation location)
<b>CASAMBI</b>	Contact factory for CASAMBI READY options

## NOTES:

- Must specify voltage, not available with 347V.
- Contact factory for other emergency ballast options.
- To find an approved dimmer switch, please see table 1.
- Lumen per watt is around 15% less than standard CRI (80+).
- Shipped separately.
- Its default setting can be found on the IR-TEC installation instructions.
- A:** Standard cone shape Lens @ 15' height (up to 30' coverage)  
**B:** Extra wide cone shape Lens @ 10' height (up to 60' coverage)  
**C:** High bay cone shape Lens @ 30' height (up to 90' coverage)  
**D:** Standard round shape Lens @ 20' height (up to 40' coverage)  
**F:** Extra wide dome shape Lens @ 20' height (up to 80' coverage)  
**G:** Aisle way arch shape Lens @ 40' height (up to 120' coverage)
- Refer to diffuser chart for compatibility.
- Order "RS-LRD" to adjust sensor setting.
- Integrated Microwave bi-level Occupancy Sensor, adjustable via DIP switch(Mounted inside fixture).
- Not available with narrow body.
- DesignLights Consortium® (DLC) qualified product. Not all versions of this product may be DLC qualified. Please check the DLC Qualified Products List at [www.designlights.org/QPL](http://www.designlights.org/QPL) to confirm which versions are qualified.
- Not available with 4ft and 8ft.

## DIFFUSER

	2FT	4FT	8FT	
PIRA	O	O	X	Polycarbonate, Linear Ribbed Clear Lens
PIRAFR	O	O	X	Polycarbonate, Linear Ribbed Frosted Lens
DIRA	O	O	O	Impact resistant acrylic, Linear Ribbed Clear Lens
DIRAFR	O	O	O	Impact resistant acrylic, Linear Ribbed Frosted Lens
PCC	O	O	O	Polycarbonate, smooth clear lens
PCF	O	O	O	Polycarbonate, smooth frosted lens
IAC	O	O	O	Impact resistant acrylic, smooth clear lens
IAF	O	O	O	Impact resistant acrylic, smooth frosted lens
IACD	O	O	O	Deep impact resistant acrylic clear lens
IAFD	O	O	O	Deep impact resistant acrylic frosted lens
NPIRA	X	O	X	Polycarbonate, Narrow Linear Ribbed Clear Lens
NPIRAFR	X	O	X	Polycarbonate, Narrow Linear Ribbed Frosted Lens
NDIRA	X	O	X	Impact resistant acrylic, Narrow Linear Ribbed Clear Lens
NDIRAFR	X	O	X	Impact resistant acrylic, Narrow Linear Ribbed Frosted Lens
NPCC	X	O	X	Polycarbonate, Narrow smooth clear lens
NPCF	X	O	X	Polycarbonate, Narrow smooth frosted lens
NIAC	X	O	X	Impact resistant acrylic, Narrow smooth clear lens
NIAF	X	O	X	Impact resistant acrylic, Narrow smooth frosted lens

## DW-LP LED

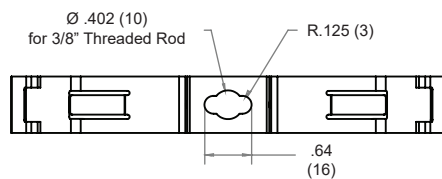

Bracket for DP option

## DIMENSION:

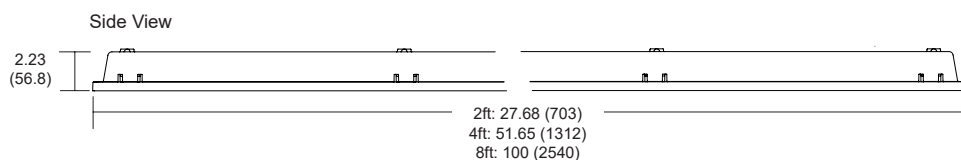

Interior View

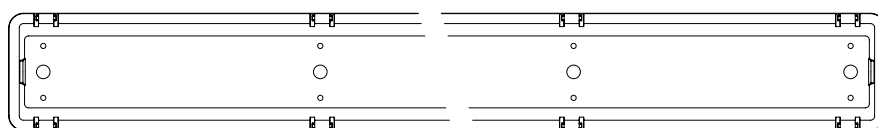

Top View

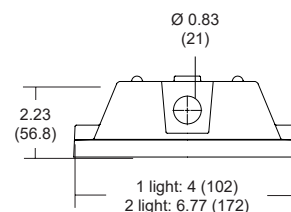

All dimensions are in inches (millimeters).

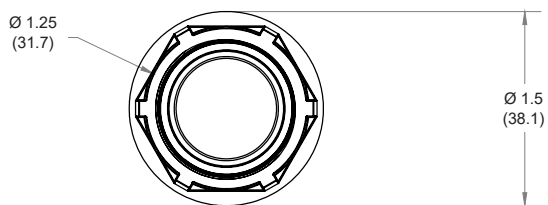

DC01

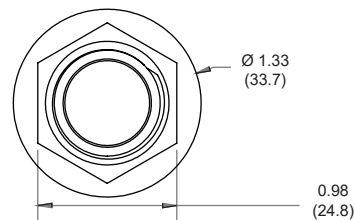

DC02

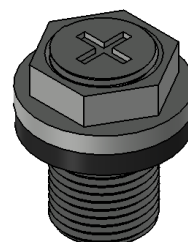
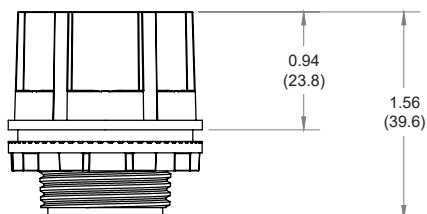



**PIRA, DIRA**  
Linear Ribbed Clear Lens



**PIRAFR, DIRAFR**  
Linear Ribbed Frosted Lens

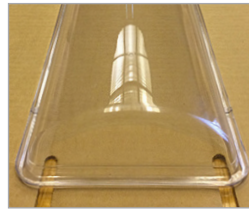

**PCC, IAC**  
Smooth Clear Lens



**PCF, IAF**  
Smooth Frosted Lens



**IACD**  
Deep Impact Resistant Clear Lens



**IAFD**  
Deep Impact Resistant Frosted Lens



**NPIRA, NDIRA**  
Narrow Linear Ribbed Clear Lens



**NPIRAFR, NDIRAFR**  
Narrow Linear Ribbed Frosted Lens



**NPCC, NIAC**  
Narrow Smooth Clear Lens



**NPCF, NIAF**  
Narrow Smooth Frosted Lens

**NPCC, NPCF, NIAC, NIAF Lens**

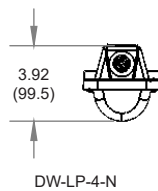

**NPIRA, NDIRA, NPIRAFR, NDIRAFR Lens**

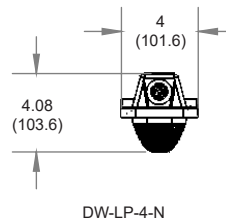

**PCC, PCF, IAC, IAF Lens**

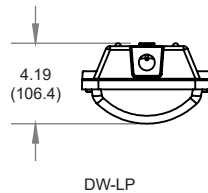

**PIRA, DIRA, PIRAFR, DIRAFR Lens**

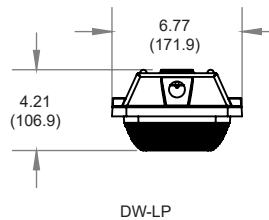

**IACD, IACF Lens**

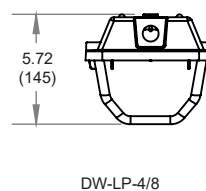
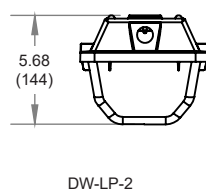

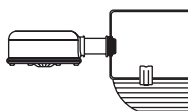

WMS, WDMS, LOD-500S-x

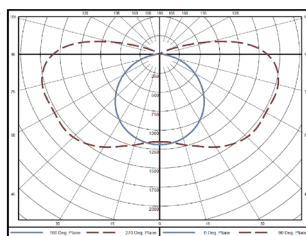

W Distribution : wide

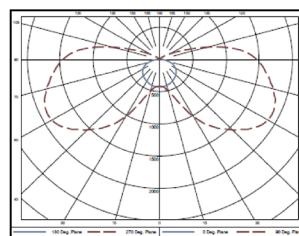

PG Distribution : parking garage

## MOUNTING INFORMATION:



Surface Mount (Std.)

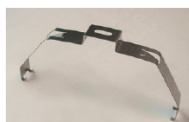

Chain/Cable Pendant Mount



Single/Double Pendant Mount



45 Degree Mount



## APPROVED DIMMER SWITCH (TABLE 1)

	Manufacturer	Manufacturer Part #
GR	LUTRON	NTSTV-DV
	LEVITON	IP710-DLZ
PH	LUTRON	Nova: NDTV- dimmer plus PP-DV relay pack(s) Nova T: NTSTV-DV-dimmer Diva: DDTV-dimmer, DVSCSTV-dimmer, plus PP-DV relay pack(s), DVSTV-dimmer, DVSCSTV-dimmer GRAFIK Eye QS: QSGRJ-XP, plus GRX-TVI 0-10V interface GRAFIK Eye QS with EcoSystem: QSGRJ-XE, QSGR-XE, plus GRX-TVI 0-10V interface PowPak: RMJ-5T
	LEVITON	Leviton: IP710-LFZ
	PHILIPS	Sunrise - SR1200ZTUNV
	OSRAM	ZBHA-CLM DIM (NAED:45678)
OS, OS1	ENCELIUM EMS	EN-LCM-1R10V-GB2-BK, EN-LCM-1R10V-GB2-BK/DR, EN-ALC-1R10V-GB2-BK, EN-ALC-1R10V-GB2-BK-DR
	LEVITON	IP710-DLX
	LUTRON	DVTV-XX
	WATTSTOPPER	ADF-120277
	SYNERGY LIGHTING CONTROLS	ISD BC
	WATTSTOPPER	FD-301
	WATTSTOPPER	FSP-202
	ENLIGHTED INC.	SU-3E-00 (Enlighted Compact Sensor)

\* If you want other specific kind, please contact us.

## HC403 FACTORY SETTING (TABLE 2)

Detection Area	100%
Hold-time	5 sec
Daylight sensor	Disable
Stand-by period (tri-level control)	10 sec
Stand-by dimming level	10%

\* See a separate attachment to find more setting options.

## DW-LP LED

DW-LP-2-18LED

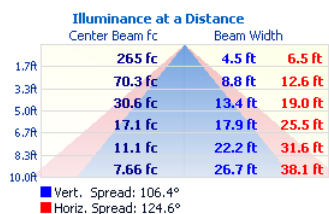

DW-LP-2-20LED

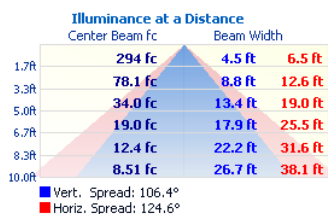

DW-LP-2-27LED

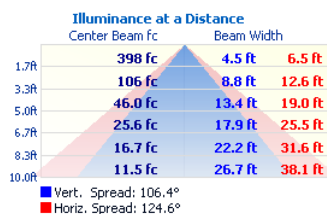

DW-LP-2-36LED

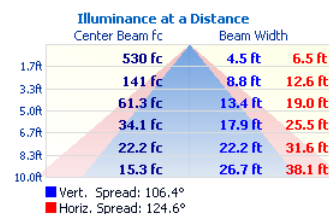

DW-LP-4-36LED

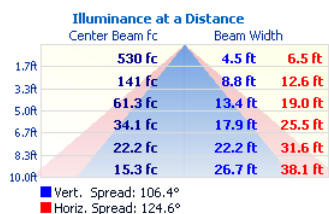

DW-LP-4-45LED

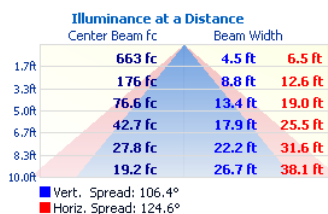

DW-LP-4-56LED

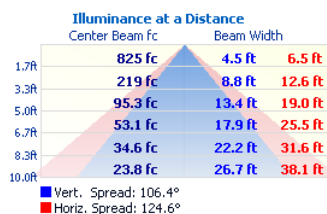

DW-LP-4-72LED

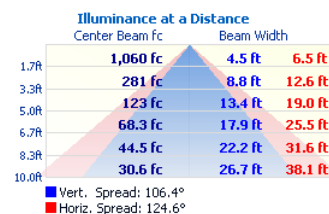

DW-LP-8-72LED

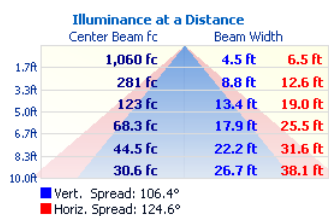

DW-LP-8-88LED

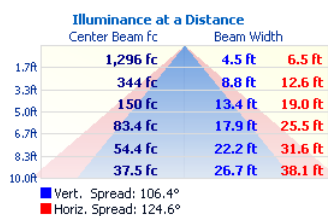

DW-LP-8-112LED

