

VR6 LED

Project Name:	
Type:	



APPLICATION

The VR6 series is a premium grade architectural linear luminaire that can be wall or ceiling mounted. It is designed to provide the extra level of protection and security required in high occupancy public areas.

FEATURES:

- Heavy 20 gauge steel material body. Includes knockouts for surface conduit and tandem mounting.
- UV stabilized polycarbonate lens available in frosted.
- Precision die formed 20 gauge full reflector that also acts as a wire cover with 92% reflectivity.
- Paint after fabrication.

MOUNTING:

- Surface wall, ceiling and pendant mount.
- Can be continuous row mounted as needed.

LED:

- High quality array LEDs.
- LM80
- Color Temperature: 2700/3000/3500/4000/5000 (K)
- Color Rendering Index: > 82.8
- Calculated L70: 122,000 hours
- Reported L70: +60,000 hours

ELECTRICAL:

- High power factor electronic driver, operate from a 120 ~ 277 Vac input range, 50 / 60 Hz.
- Features included over voltage protection, surge, short circuit protection and over load protection.
- Power Factor: typical > 0.95, THD <20, meets Class1 or Class 2 circuit.
- Generic : 0-10V 10% dim. (GR)
- Operating temperature: -4°F (-20°C) ~ 122°F (50°C).

<ELCU-200>

- Guarantees emergency lighting remains ON or is turned on when power to the control device is lost.
- Interfaces with fire alarm panel or security system.
- "Watchdog" feature allows emergency loads to be controlled in tandem with normal power loads.
- UL listed for use in emergency circuits.

LISTING:

- ROHS.
- UL / CUL listed.
- Listed to UL 1598 and UL 8750.
- Suitable for damp location.
- CEC Compliant EM (please contact for more information)
- ARRA compliant (optional).
- BAA compliant (optional).
- Trade Agreements Act compliant (optional).
- 7 or 10 years limited warranty. (optional) ³
- Bluetooth Mesh System available, please contact factory for more information.

CONFIGURATIONS

Size	LED Watts	System Lumen	Color Temp.	CRI
4FT	36LED	3985 lm +	4000K	> 82.8
	40LED	4428 lm +		
	54LED	5977 lm +		
	72LED	7969 lm +		

OUTPUT CURRENT

		Bi-Level		Tri-Level (Default)	
SW1	SW2	Config Range	Default	Config Range	Default
Close	Open	10% - 70%	40%	10% - 70%	30%
Open	Close	10% - 70%	40%	10% - 70%	70%
Close	Close	100%	100%	100%	100%
Open	Open	0%	0%	0%	0%

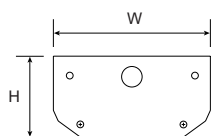

Specifications: VR6
 Height : 3.37 (85.7)
 Width : 6.5 (165.1)
 4' Length : 48 (1219.2)

All dimensions are in inches (millimeters).

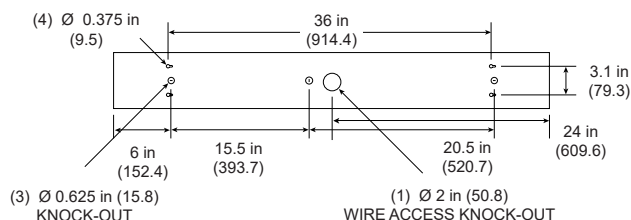
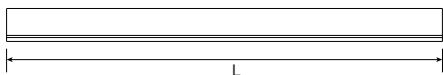

VR6 LED

ORDERING INFORMATION

EXAMPLE: VR6-4-36LED-40K-UNV

MODEL		LENGTH		LED		COLOR TEMP.		EFFICACY		CRI	
VR6	(Blank)	4	4' Length	36LED 40LED 54LED 72LED	36W LED 40W LED ¹ 54W LED 72W LED	-27K -30K -35K -40K -50K	2700K ² 3000K 3500K 4000K (Std.) 5000K	(Blank) HE	Standard High Efficacy 	(Blank) C9	80+ CRI 90+ CRI ³

* Contact factory for custom wattage or lumen requirement.

LENS		VOLTAGE		LED DRIVER ⁴	
(Blank)	Frosted	UNV 120 277 347	120-277V (Std.) 120V 277V 347V	GR DM1 SD40 SDXX TDM TD30/70 TDXX/YY ES566 EC LDE1 ELV PHSR PHDL LTEA2W	Generic, 0-10V 10% dim (Std.) Generic 0-10V 1% dim 40% / 100% Bi-Level Step dim XX% / 100% Bi-Level Step dim (Specify XX : 10% ~ 70%) Triac Dim. (120V only) 30% / 70% / 100% Tri-Level Step dim XX% / YY% / 100% Tri-Level Step dim (Specify XX, YY : 10% ~ 70%) eldoLED SOLOdrive Natural Dimming to dark, 0-10V, 100% ~ 0.1% dim eldoLED ECOdrive 0-10V natural dim to 1% (Hybrid HydraDrive) Hi-lume 1% EcoSystem LED driver with Soft-on, Fade-to-Black dimming technology, 100% ~ 1% dim ELV compatible (reverse-phase or trailing-edge), (120V only) Philips Xitanium Sensor-Ready, Dali 5%~100% dim Philips Xitanium DALI driver, Dim to 5% Hi-lume 1% 2-wire LED driver (120V forward phase only)
				 BLT	Bluetooth Mesh System (contact factory for more information)

OPTIONS

EMG8 EMG15 EMG20 EMG25 ELCU-200 HC403 LRD-509S-x LOS-502S-x RS-LRD	8W EM Battery Backup (CEC Compliant EM) ^{5,6} 15W EM Battery Backup (CEC Compliant EM) ^{5,6} 20W EM Battery Backup (CEC Compliant EM) ^{5,6} 25W EM Battery Backup (CEC Compliant EM) ^{5,6} Fail-to-on Emergency lighting, UL924 ⁷ Microwave bi-level Occupancy Sensor, adjustable via DIP switch ⁸ Ceiling Surface mounted 0-10V SmartDIM or multi-level high/low dim control occupancy sensor 120-277V, Fail on, (*IR remote programmable) (See note 10 to select lens for "x") ⁹ Ceiling Surface mounted ON/OFF PIR Occupancy sensor, No dimming support. 120/277V. Dip switch setting, Fail on (See note 10 to select lens for "x") ⁹ Remote programmer for LRD-509S	GTD GTD10DIM TR AMB ARRA BAA TAA O7W O10W	Bodine Generator Transfer Device Bodine Generator Transfer Device (0-10VDC Dimmer Override) Vandal Resistant Anti-Microbial Coating (Matte Skye White) Assembled in USA BAA(Buy American Act) compliant Trade Agreements Act compliant Optional 7 Years Limited Warranty ¹¹ Optional 10 Years Limited Warranty ¹¹
--	---	---	---

LIGHTING CONTROL SYSTEM

LUTRON VIVE	<Lutron Vive System Enabled>  Click Here!
SNS200C RS-IR	<EasySense> EasySense Ceiling-mount occupancy sensing, daylight harvesting and task tuning in one device (Must be ordered with PHSR driver) IR dongle v2.0 for EasySense control
PPA102S CASAMBI	<Bluetooth> Bluetooth Powerpack (Consult factory for installation location) Contact factory for CASAMBI READY options

NOTES:

- Not available with GR driver.
- Available with C9 only.
- Lumen per watt is approximately 15% fewer than standard CRI (80+).
- To find an approved dimmer switch, please see Table1.
- Contact factory for other emergency ballast options.
- Not available with 347V.
- Shipped separately.
- See Table2 to find default setting.
- Default setting can be found on the IR-TEC category.

- A: Standard cone shape Lens @ 15' height (up to 30' coverage)
B: Extra wide cone shape Lens @ 10' height (up to 60' coverage)
C: High bay cone shape Lens @ 30' height (up to 90' coverage)
D: Standard round shape Lens @ 20' height (up to 40' coverage)
F: Extra wide dome shape Lens @ 20' height (up to 80' coverage)
G: Aisle way arch shape Lens @ 40' height (up to 120' coverage)
H: High bay dome shape Lens @ 50' height (up to 50' coverage)

- This limited warranty covers electrical parts only and does not apply to labor, equipment lease, or defect from improper installation or operation. (EM battery backup does not included).

VR6 LED

COMPATIBLE DIMMER SWITCH (TABLE 1)

Model #	Brand	Compatible Dimmer Switch	
(Blank)	-	<Leviton>	IlumaTech IP7 series
		<Lutron>	Visit www.lutron.com/advance for a list of dimmers (Mark VII) that will work with this driver.
		<Philips>	Sunrise : SR1200ZTUNV
ES566	eldoLED SOLOdrive	<Busch-Jaeger>	2112U-101
		<Jung>	240-10
		<Leviton>	IlumaTech - IP710-DLX
		<Lightoller Controls>	ZP600FAM120
		<Merten>	5729
		<Pass & Seymour>	CD4FB-W
		<Wattstopper>	DCLV1
		<Sensor Switch>	nIO EZ
		<Synergy>	ISD BC
		<ABB>	SD/S 2.16.1
		<Lutron>	Nova T: NTFTV Diva - DVTv-xx, NFTV GRAFIK Eye: GRX-TVI w GRX3503 Energy Savr Node: QSN-4T16-S TVM2 Module
		<Crestron>	GLX-DIMFLV8, GLXP-DIMFLV8, GLPAC-DIMFLV4-*, GLPAC-DIMFLV8-*, GLPP-DIMFLVEX-PM, GLPP-1DIMFLV2EX-PM, GLPP-1DIMFLV3EX-PM, DIN-A08, DIN-4DIMFLV4, CLS-EXP-DIMFLV, CLCI-1DIMFLV2EX
LDE1	Lutron Hi-lume 1% EcoSystem	<Lutron>	PowPak Dimming Modules: RMJ-ECO32-DV-B, FCJ/FCJS-ECO ^{1,2} Energi Savr Node (120V only): QSN-1ECO-S, QSN-2ECO-S GRAFIK Eye QS/Homeworks QS control unit (120V only): QSGRJ- _E(wireless) QSGR- _E Quantum Hub (120V only): QP2- _2C/4C/6C/8C Homeworks QS/myRoom Plus power module (120V only): LQSE-2ECO-D
TDM	KEystone	<Lutron>	Diva DV-600P, SkyLark S-600P, Ariadni AY-600P, Ariadni TG-603P, Maestro MA-600 (Digital), Diva CFL/LED DVCL-153P, Satin Colors DVSC-600P-SW
		<Leviton>	6641, IlumaTech IPI06-1LX, ToggleTouch TGI06-1LW (Digital)
ELV	KEystone	<Lutron>	MAELV-600BL (Digital), DVELV-300P, SkyLark SELV-300P
LTEA2W	Lutron Hi-lume 2-wire (120V forward voltage only)	<Lutron>	Visit http://www.lutron.com/TechnicalDocumentLibrary/369543_ENG.pdf for a list of compatible dimmer switches.

NOTES:

- All devices connected to one FCJ/FCJS-ECO will be controlled together. Devices will dim to the same level as the result of a control command.
For more detail on adjusting low-end light level refer to Application Note#556 at www.lutron.com.
- For the Line/Hot (L/H) terminal on the driver, it is preferred not to use the switched hot (red) wire from the control but rather the hot wire directly from the power source.

HC403 FACTORY SETTING (TABLE 2)

Detection Area	100%
Hold-time	5 sec
Daylight sensor	Disable
Stand-by period (tri-level control)	10 sec
Stand-by dimming level	10%

* See a separate attachment to find more setting option