

RONDO2-TW

Rotational LED

Project Name:	
Type:	

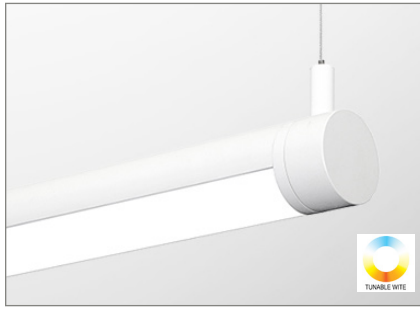

APPLICATION

Tunable White technology can mimic the natural daylight to support Circadian Rhythm - the biological clock, innate in the human body affected by the color temperatures. Ability to adjust color temperature and the light source intensity can enhance synchronization of bodies and minds, essential to ensure maximum productivity during the course of the day. This tunable technologies can provide the ultimate solution to optimize the needs from residential to commercial, healthcare, education, retails, entertainment, office, and more.

MOUNTING:

- Pendant.
- Wall mount.

FINISH:

- Standard powder-coat textured white painted finish on exposed trim, consult factory for custom colors.
- Comes with snap-in acrylic lens as standard.

LISTING:

- UL /cUL listed.
- Listed to UL 1598 and UL 8750.
- UL listed for dry & damp location.
- ARRA compliant.
- Warranty:
 - 265K & -275K : 5 years limited warranty.
 - 3065K : 3 years limited warranty.
- Power source: 5 years limited warranty.

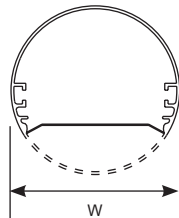

Specifications: RONDO2

Width: 2-1/2 Dia. (63)

All dimensions are in inches (millimeters).

ORDERING INFORMATION

EXAMPLE: RONDO2-IND-4-27L-30K-UNV

MODEL	ROW ¹	SECTION ²	ANGLE
RONDO2-IND (Individual Mount) RONDO2-CON (Continuous Row Mount)	xx Specify nominal overall row length in 1' increments (Continuous runs) <small>* Number of circuit(s) should be determined by the customer prior to ordering the continuous run considering the AC input voltage and total run wattage.</small>	2 2' Length 3 3' Length 4 4' Length 8 8' Length ³ X Custom Length ⁴	(Blank) Down 45 45° 90 90° 135 135° 180 180°
	X"x"-Y"y" Specify dimensions in inches (Minimum required dimensions is 2'4"-2'4", 2' increments), (Straight joint provided over 8ft run in length). <small>* Must provide a sketch on the last page.</small>		
RONDO2-SQ (Square)			
RONDO2-CM (Custom)	Refer to dimensions page to calculate the total run <small>* Must provide a sketch on the last page.</small>		

RONDO2-TW

WIRED SOLUTION 6

LED		SYSTEM		CRI		LED DRIVER	
18L	18W LED (598 lm/ft)	-265K -275K -CCK	Tunable White 2000-6500K Tunable White 2700-5000K Tunable White custom CCT from 2000-6500K (Must specify the CCT range)	(Blank) C9	80+ CRI 90+ CRI 8	ED560	eldoLED LightShape DALI dim to dark, 0.1% ~ 100%
27L	27W LED (898 lm/ft)					MU050	0-10V dual channel, 1% ~ 100%
36L	36W LED (1197 lm/ft)					PSQ02U	T-Series 1% 2-channel tunable white driver
48L	48W LED (1597 lm/ft)					V010V	Bridgelux VESTA 0-10V
54L	54W LED (1796 lm/ft)					VDALI	Bridgelux VESTA DalI2 DT8
* Contact factory for custom wattage or lumen requirement.							

CONTROLS	
DUALSWT-WH	2-1 Dual wall switch, 120v only, white finish 5 * Only with *MU050* driver.

WIRELESS SOLUTION 7

LED		SYSTEM		CRI		LED DRIVER		CONTROLS 6, 7	
(Blank) DLO	No Downlight Low output, 6 W/ft, 512 lm/ft	-3065K	Tunable White 3000-6500K With wireless solution 5	(Blank)	90+ CRI 8	CV24	24VDC power supply	MZ-TW BLT	4-zone RF remote, white finish Bluetooth / Smartphone App
DHO	High output, 12 W/ft, 1024 lm/ft					2DMX	2-channel DMX512 decoder		
(Blank) 18L 27L 36L 48L 54L	No Downlight 18W LED (598 lm/ft) 27W LED (898 lm/ft) 36W LED (1197 lm/ft) 48W LED (1597 lm/ft) 54W LED (1796 lm/ft)	-265K -275K -CCK	Tunable White 2000-6500K Tunable White 2700-5000K Tunable White custom CCT from 2000-6500K (Must specify the CCT range)	(Blank) C9	80+ CRI 90+ CRI 8	(Blank)	Bridgelux VESTA	VWSC VWIZ VSVR VCAS	Bridgelux VESTA Wisilica Bluetooth Bridgelux VESTA WIZ-connected Wi-Fi Bridgelux VESTA Silvair Bluetooth Mesh Bridgelux VESTA Casambi Bluetooth Mesh
* Maximum wattage per 4ft section - pendant/wall mount : 75W (up & down light) * Contact factory for custom wattage or lumen requirement.									

MOUNTING		VOLTAGE		POWER FEED LOCATION		FINISH			CORD FINISH	
(Blank) W5 W12	Pendant 5" Wall Mount 12" Wall Mount	UNV 120 277	120-277V 120V 277V	PL	Power location must be provided in the drawing * Required for -SQ, -CM and -CON model only.	(Blank) *BK *SV **CC *CSS *AMB	Matte White RAL #9003 (Std.) Black RAL #9011 Silver RAL #9022 Custom Color Custom Canopy Color (White is Std.) Anti-Microbial Coating (Matte Skye White)		(Blank) BKC	White (Std.) Black * Black cord additional charge.
* Non-standard finish with extra charge. ** CC: additional charge & set up fee. Provide RAL# code.										

CEILING TYPE		SUSPENSION LENGTH		OPTIONS	
X1	15/16" grid T-bar ceiling	AC48	Adjustable Aircraft Cable Canopy 48"L	LC	Non-lit 90° coupling
X2	Hard ceiling	AC96	Adjustable Aircraft Cable Canopy 96"L	TC	Non-lit T-shape coupling
X3	Sloped Hard ceiling	ST24	Stem Canopy 24"L	XC	Non-lit X-shape coupling
X4	9/16" T-bar ceiling	ST48	Stem Canopy 48"L	LC-VD	Non-lit 90° vertical drop
* Contact factory for custom length.					
LC-BT Non-lit 90° bottom					
TC-VD Non-lit T-shape vertical drop					

NOTES:

- Specify only when Continuous Row Mount.
- No need to select, if same as row length and section length.
- Comes with 1pc 8ft lens.
- Certain restrictions apply such as wattage and length, please consult with the factory.
- Custom wattage or lumen not available.
- Refer to Table1 to find more information.
- Refer to Table2 to find more information.
- Lumen per watt is approximately 15% less than standard CRI 80+.

RONDO2-TW

WIRED SOLUTION (TABLE 1)

SPECIFICATION CHART

	-265K	-275K
Tunable Range	2000 - 6500K	2700 - 5000K
Lumen Efficiency	2500 lm/ft (at 3500K), >115 lm/W	
CRI	80+ (90+ optional)	
Dimming	0.1% - 100%	
Color Consistency	3-step MacAdam binning	
Lumen Maintenance	> 50,000 hours	
Control Options	DALI (#ED560), 0-10V (#MU050), Lutron T-Series (#PSQ02U), V010, VDALI	
Warranty	5 years limited warranty	

COMPATIBLE DIMMER SWITCH CHART

Model #	Brand	Compatible Dimmer Switch	
ED560	eldoLED DUALdrive	<Lunatone>	SS-LUNAT PS2 30mA SS-LUNAT Touch or BT SS-LUNAT Comm
MU050	Moons Intelligent indoor	<Lutron>	Diva - DVTV-xx, DVSTV-xx
PSQ02U	Lutron	<Lutron>	Quantum System Network
V010V	Bridgelux	Industry standard 0-10V dimmer switch	
VDALI	Bridgelux	Industry standard DALI2 DT8 devices	

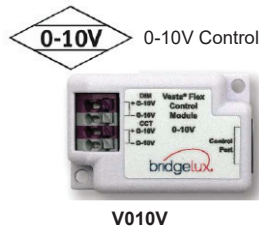

- 0-10V control protocol.
- Two channel control of color temperature and intensity.
- Compatible with industry standard 0-10V current sourcing or 10V current sinking wired control devices

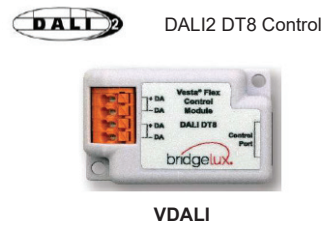

- DALI2 DT8 certified.
- Two channel control of color temperature and intensity.
- Compatible with industry standard DALI2 DT8 devices.
- Commission and manage lighting fixtures via any DALI2 certified controller.

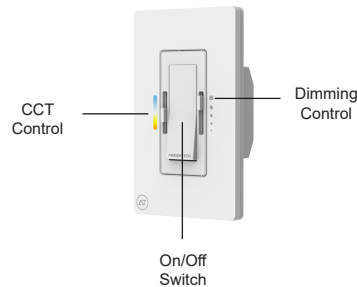

* Wall Plate included

DUALSWT-WH

Input	120VAC, ~60Hz
Max Load	600W
Dimming Curve	Linear, PWM
Compatibility	eldoLED DUALdrive, Moon's 0-10V Dual Series
Features	Field adjustable low-end trim, Built-in Relay
UL listed	UL 1472 / CSA C22.2 184.1
FCC	Class B Part 15



RONDO2-TW

WIRELESS SOLUTION (TABLE 2)

	-265K	-275K	-3065K
Tunable Range	2000 - 6500K	2700 - 5000K	3000 - 6500K
Lumen Efficiency	2500 lm/ft (at 3500K), >115 lm/W		512 lm/ft , up to 87.5 lm/W
CRI	80+		90+
Dimming	0.1% - 100%		PWM
Color Consistency	3-step MacAdam binning		-
Lumen Maintenance	> 50,000 hours		> 50,000 hours
Control Options	Bridgelux VESTA Bluetooth Mesh & Wi-Fi. Wisilica, WIZ, Silvoir, Casambi		Wireless remote, Bluetooth (Smartphone / APP)
Warranty	5 years limited warranty		3 years limited warranty

-265K & -275K (CONTROLS)

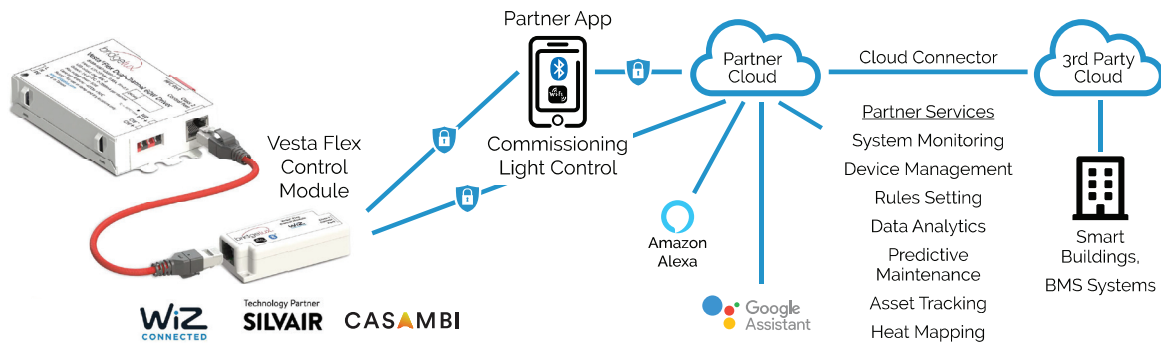

WISILICA BLE Control



VVSC

- Connect lighting fixtures to an intelligent non-flooding BLE mesh network
- Commission and manage lighting fixtures via iOS and Android apps or web portal.
- Interoperates with beacons and sensors via BLE.
- Large ecosystem of compatible sensors, switches, gateways, 3rd party clouds.
- Cloud services such as system monitoring, device management, predictive maintenance, asset tracking, data analytics.



WIZ Wi-Fi Control



VVWIZ

- Connect lighting fixture to the internet via Wi-Fi; no hub needed.
- Interoperates with sensors via BLE.
- Commission and manage lighting fixtures via iOS and Android apps or web portal.
- Large ecosystem of compatible sensors, switches, gateways, cloud platform.
- Cloud services such as system monitoring, device management, predictive maintenance, asset tracking, data analytics.



SILVAIR BLE Control



VSVR

- Interoperability with standard BLE mesh lighting ecosystem.
- iOS app and web portal interface options.
- Seamless device commissioning.
- Rules setting and supervision, energy usage monitoring.
- Data gathering on usage, locations, users, time of day.
- Automation based on users and sensors.
- Ecosystem with sensors, switches.
- Firmware updates over the air.
- Customizable and integration-ready APIs.



CASAMBI BLE Control



VVCAS

- Casambi proprietary Bluetooth Low Energy mesh protocol.
- iOS app and Android app interface options.
- Seamless device commissioning.
- Rules setting and supervision, predictive maintenance.
- Data gathering on usage, locations, users, time of day.
- Automation based on users and sensors.
- Firmware updates over the air.
- Customizable and integration-ready APIs.
- Ecosystem with sensors and switches, and luminaires.
- Multi level security.



RONDO2-TW

-3065K (CONTROLS)



WL-MZ-WH (Wireless Wall remote)

Dimensions	L 4.3" x W 2" x D 0.85"
Weight	0.1 lbs
Signal Type	RF (Radio Frequency) 2.4GHz
Zone	4 zone
Range	98ft from fixture
Working Temp.	-4°F to 131°F (-20°C to 55°C)
* Battery	2 x AAA battery

* Not included.



Smart Life



Tuya Smart

BLT (Bluetooth / Smartphone App)

Bluetooth	
Software	IOS 8.0 and up, Android 4.4 and up
App	Smart Life or Tuya Smart supported
Features	Group, Scenes
Bluetooth Distance	> 49ft in open area
Additional Feature	Home Management / Third party control -> Alexa, Google Assistant (by others)

2DMX



2DMX (2-channel DMX decoder)

Dimensions	L 7" x W 1.8" x D 1.2"
Output Current	8A / channel
Input Voltage	12-24V DC
Output Power	384W @ 24V
Frequency	PWM

RONDO2-TW

*Fixture can be customized: angle 45°, 90°, 135°, 180° (up light).
 *Field adjustable using allen key (provided).

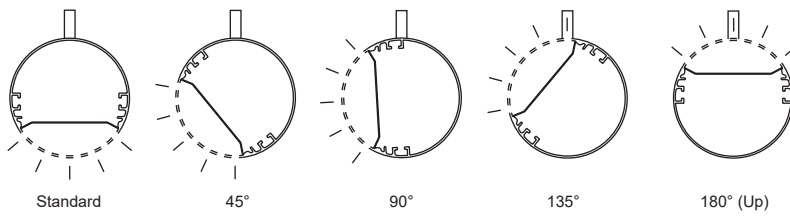

WALL MOUNT

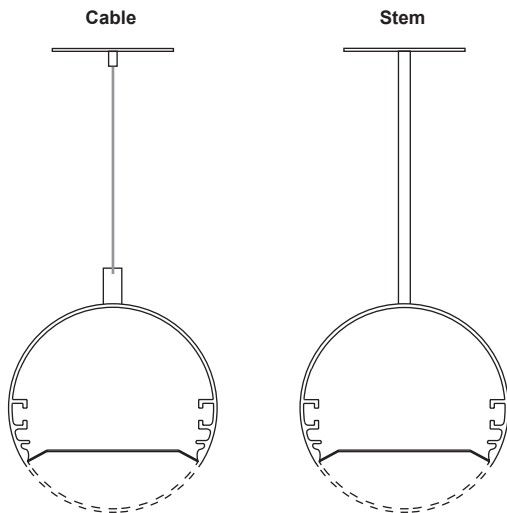

*Compatible with 1/2" pipe stem (provided by others).

WEIGHT

Item	lbs	kg
RONDO2-2	5.08	2.3
RONDO2-3	6.01	2.72
RONDO2-4	6.76	3.06
RONDO2-8	10.88	4.93

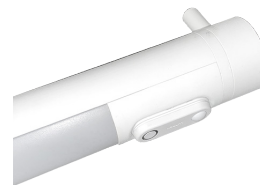

Lutron Vive Integral fixture control installation

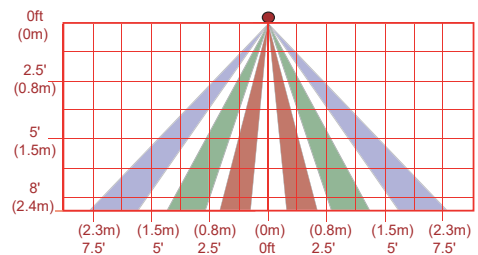

AMS coverage pattern (side view)

* The coverage shown in the diagram is maximum.
 AMS is designed to detect small motion when mounted within 6' occupants.

RONDO2-TW

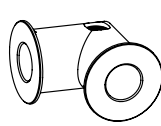
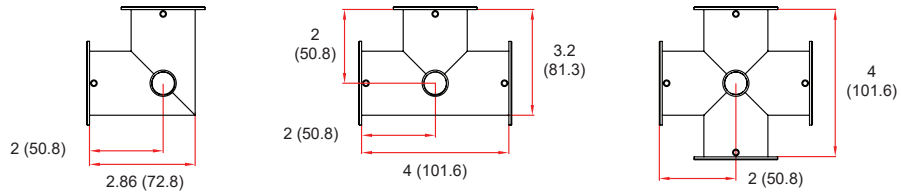

LC

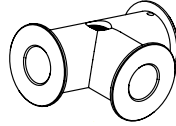

TC

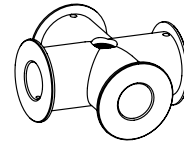

XC

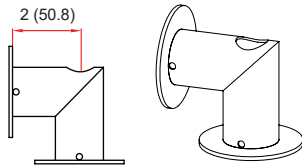

LC-VD

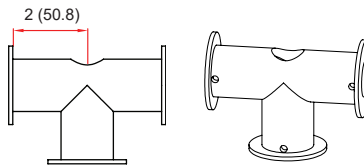

TC-VD

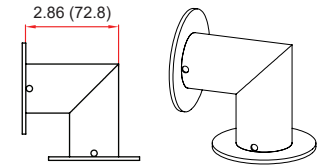

LC-BT

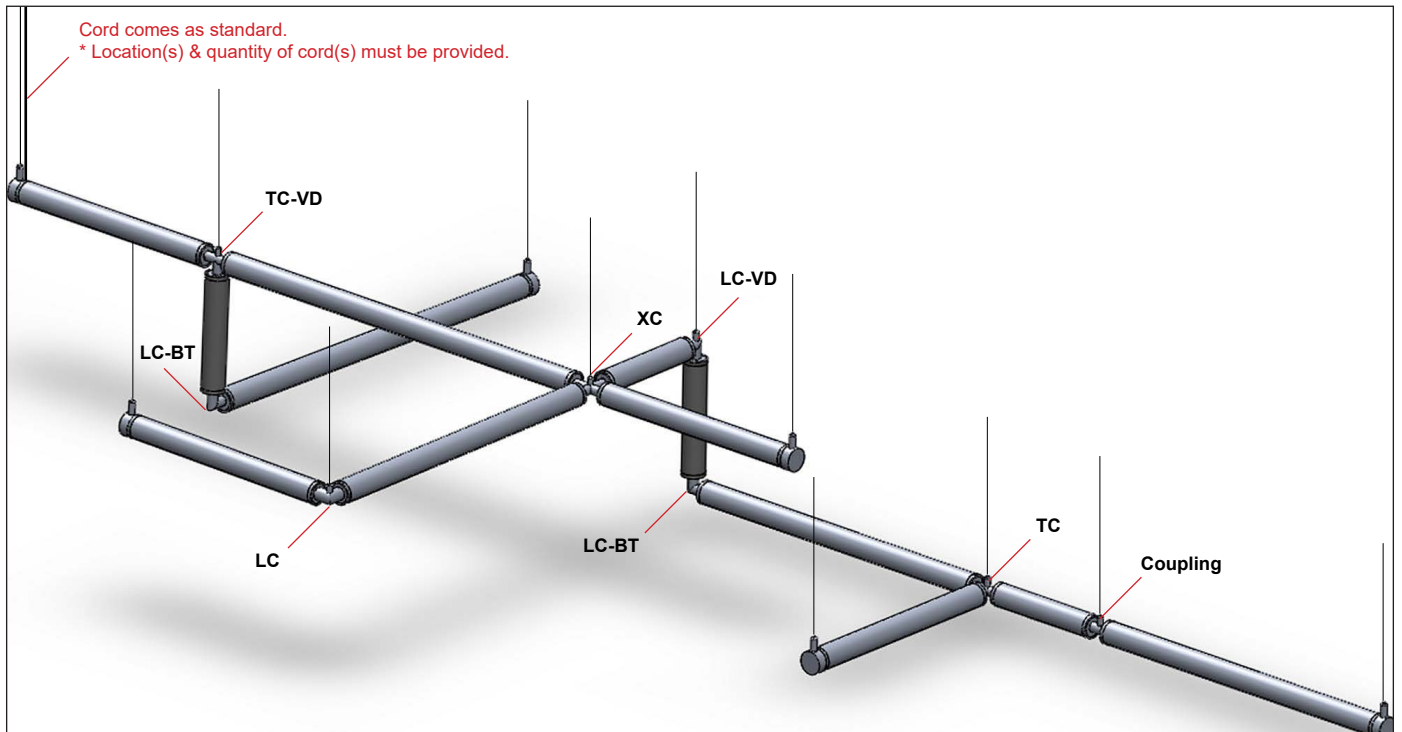

RONDO2-TW

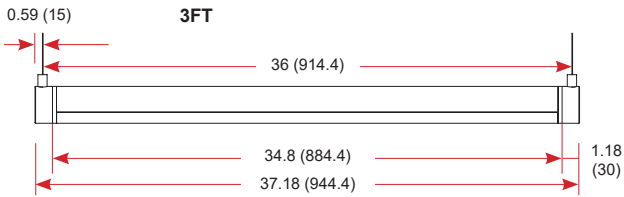
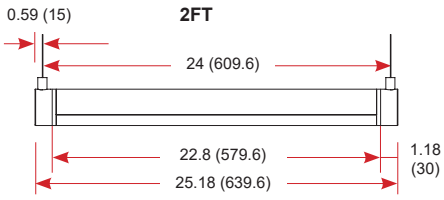

All dimensions are in inches (millimeters).

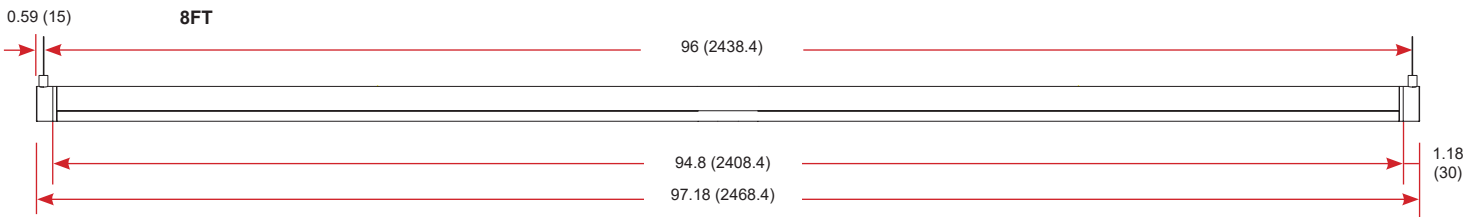
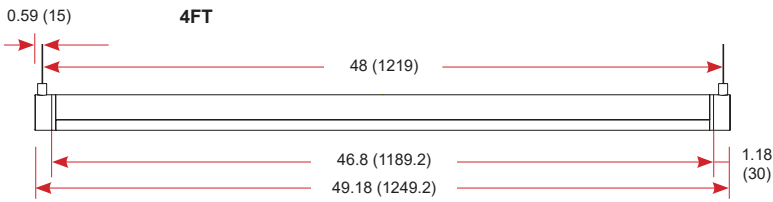

Coupling

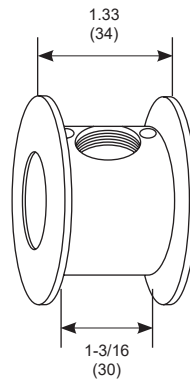

Coupling for continuous run

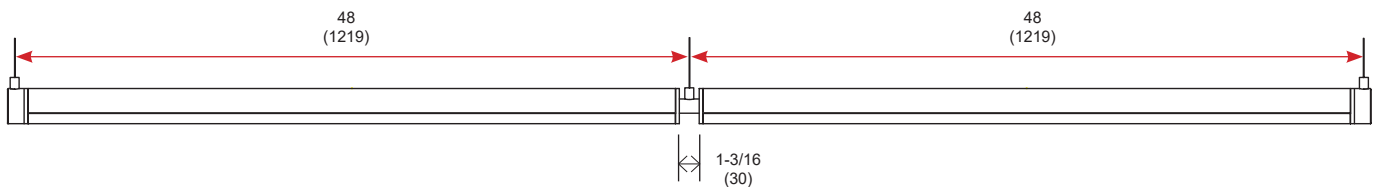

Total run = 97.05 (2465)
 Calculation: (1245-30)x2+30 = 2460
 * Recommended to calculate in mm. for precised measurement.

RONDO2-TW

RONDO2-SQ examples (Measurement from center point)

2'4"-2'4" (Minimum)

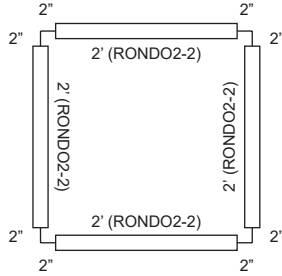

10'5.2"-2'4" (Minimum)

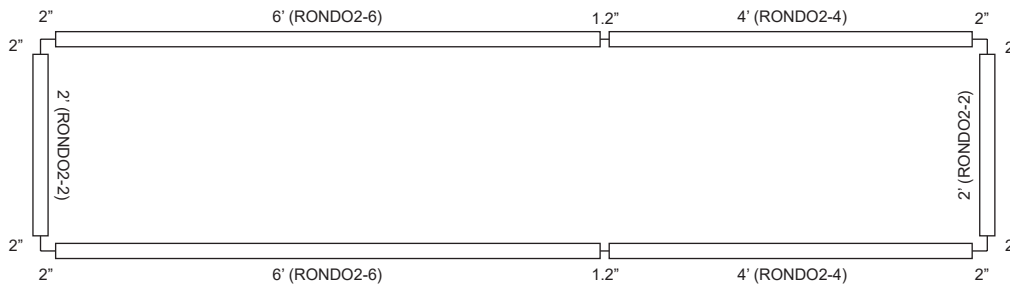

RONDO2-CM examples (Measurement from center point)

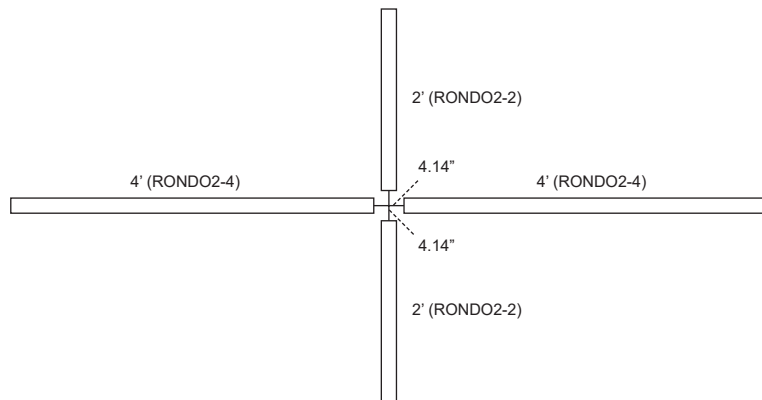
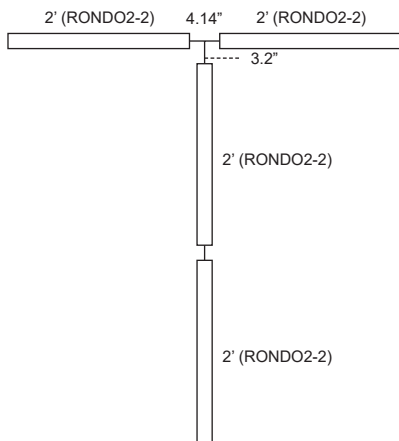

ARCHITECTURAL TUNABLE WHITE LINEAR

RONDO2 NON-LIT CONNECTOR PATTERNS

Instruction:

- Provide sketches illustrating corner types and overall dimensions.
- Must provide the power location in the drawing.
- Utopia Lighting will decide the optimal fixture combination unless otherwise specified in the drawing

