

LAD6C

Project Name:	
Type:	



APPLICATION

6" Horizontal commercial frame-in is non-insulated ceiling design for high wattage application with lens. Ideal for medium to high ceilings for commercial installations.

FEATURES:

- Galvanized steel plaster frame: Quality galvanized steel ring riveted to elevated steel junction box tray.
- Housing can be removed from plaster frame for junction box access.
- Mounting: Bar hanger allows fixtures to affix to T-bar grid into wood or steel joist members.
- 16-gauge galvanized steel construction.
- Maximum 1-1/2" ceiling thickness.
- Toolless adjustments post installation.
- Unique optic allows high lumen transmission while concealing the LED light source resulting in efficient, inviting light and minimizing LED glare.
- Non-insulated ceilings or where insulation can be kept 3" from all side of housing.

JUNCTION BOX:

- Galvanized steel junction box with seven 1/2" knockouts, four pryouts, and snap on cover.
- Electrical connections are made through a single junction box door.
- Access to junction box from below ceiling after removal of reflector for easy maintenance.

BAR HANGERS:

- Pre-installed adjustable bar hangers for span 24".
- No clips required. Secure bar hanger to T-bars with wires or screws.
- Integral captive nails included for fast and easy installation.

LED:

- CREE LED technology.
- 50,000 hours.
- 4000K color temperature standard.
- 16W, 25W, 38W, 50W, 70W, 100W LED.
- Color Rendering Index: > 90
- Projected L70 hours: 60,000
- NEMA ANSLG C78.377

ELECTRICAL:

- Input voltage: 120-277V
- 0-10V (dim to 1%, 120-277V)
- Operating Temperature: -4°F (-20°C) ~ 104°F (40°C)
- Thermal protection.
- Surge protection (3kV line to line, 6kV line to earth).
- Protections: Output open load, over-current and short-circuit(hiccup), and over-temperature with auto recovery.
- Conducted and radiated EMI: Compliant with FCC CFR Title 47 Part 15 Class B (120 Vac)/ Class A (277 Vac) and EN55015 (CISPR 15) at 220/230/240 Vac.
- <ELCU-200>
- Guarantees emergency lighting remains ON or is turned on when power to the control device is lost.
- Interfaces with fire alarm panel or security system.
- "Watchdog" feature allows emergency loads to be controlled in tandem with normal power loads.
- UL listed for use in emergency circuits.

LISTING:

- ROHS.
- UL/CUL listed for damp locations with covered ceiling.
- UL/CUL wet location listed with "W" lens only.
- Listed to UL 1598 and UL 8750.
- Minimum 75°C supply conductors.
- CSA certified to US.
- Energy Star certified. ⁵
- 5 years limited warranty.
- 10 years limited warranty (optional). ^{8,9}
- ARRA compliant (optional).
- BAA compliant (optional).
- BABA compliant (optional).

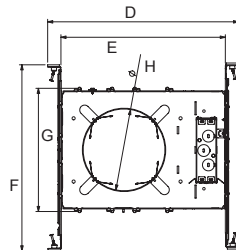

Dimensions

- D: 15-5/16" (389.2)
- E: 12-19/32" (320)
- F: 16-1/8" (410)
- G: 9-7/16" (240)
- H: 6-1/4" Dia. (159)

All dimensions are in inches. Drawings are for dimensional detail information only.

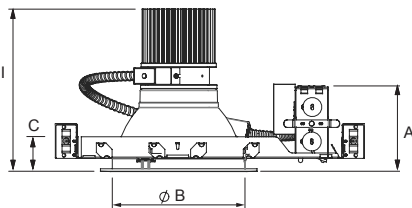

Dimensions (16W, 25W, 38W, 50W)

- A: 3-15/16" (100.6)
- B: 6-5/16" Dia. (160.6)
- C: 1-1/2" (38)
- I: 7-11/16" (195.6)

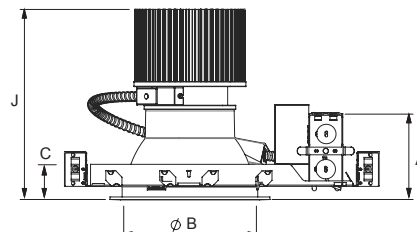

Dimensions (70W, 100W)

- A: 3-15/16" (100.6)
- B: 6-5/16" Dia. (160.6)
- C: 1-1/2" (38)
- J: 8-7/8" (224.6)

6" COMMERCIAL NEW CONSTRUCTION FRAME

ORDERING INFORMATION

EXAMPLE: LAD6C-25L-40K-UNV-DM-WW-O60

MODEL		LED				COLOR TEMP.		VOLTAGE		LED DRIVER		
LAD6C	6" Commercial Frame	11L 16L 25L 38L 50L 70L 100L	11W LED ⁶	<u>Lumen Output</u>	<u>Lumen Efficiency</u>	-27K -30K -35K -40K -50K -275K	2700K 3000K 3500K 4000K (Std.) 5000K Tunable white 2700-5000K (Max. 50W) ³	UNV 347	120-277V 347V ⁴	DM TDM ELV	0-10V(dim to 1%, 120-277V) Triac Dim. (120V only) ELV compatible (reverse-phase or trailing-edge), (120V only) 1%, Lutron (Soft Fade to Black, Ecosystem) ² 0-10V dim to 1% for -275K (Tunable White) eldoLED LightShape DALI dim to dark, 0.1% ~ 100% eldoLED POWERdrive DMX/RDM Full-color, 0.1% ~ 100% XX% / 100% Bi-Level Step dim (Specify XX: 10%~70%) ¹³ NEMA SSL 1, UL 8750 Class 1 or 2, 2kV Surge Protection, NEMA C82.77.10, driver integral thermal protection, TITLE 47 CFR 15, Class A sound rated ¹⁵	
			16W LED	1084.6 lm	98.6 lm/W							
			25W LED	1577.6 lm	98.6 lm/W							
			38W LED	2490 lm	99.6 lm/W							
			50W LED	4006.8 lm	101.96 lm/W							
			70W LED	4602 lm	98.7 lm/W							
			100W LED	6874 lm	98.2 lm/W							

EM ^{10, 11, 14}		REFLECTOR		TRIM RING		LENS		OPTIC	
EMI8	1296 LUMEN EM Battery Backup	WW	White Reflector w/ White Plastic Ring	(Blank)	White Trim Ring	(Blank)	Dry / Damp location	O20	Narrow
EMI15	2430 LUMEN EM Battery Backup	CW	Clear Reflector w/ White Plastic Ring	BK	Black Trim Ring	W	White Smooth Splay w/ Frosted Lens (Wet Location) ¹²	O40	Medium
EMI25 INT	4050 LUMEN EM Battery Backup EM Pilot Located on Reflector	PLW	Platinum Haze Reflector w/ White Plastic Ring					O60	Wide (Std.)
								WA	Wall Wash

OPTIONS		LIGHTING CONTROL SYSTEM	
ARRA	Assembled in USA	VRF	<Lutron Vive System Enabled>
BAA	BAA(Buy American Act)	FCJS0	Vive Integral fixture control (RF only, for Lutron EcoSystem drivers)
ELCU-200	Fail-to-on Emergency lighting, UL924 ¹	FCJSE	FCJS-010, Vive Attached fixture control (RF only for 0-10V drivers)
GTD	Bodine Generator Transfer Device	FCJS0EM	FCJS-ECO, Vive Attached fixture control (RF only for Lutron EcoSystem drivers)
GTD10DIM	Bodine Generator Transfer Device (0-10VDC Dimmer Override) Rough-in	FCJSEEM	FCJS-010-EM, UL 924 Emergency (Must be ordered with FCJS-010)
FRAME	frame pre-ship request ⁷		FCJS-ECO-EM, UL 924 Emergency (Must be ordered with FCJS-ECO)
O10W	Optional 10 Years Limited Warranty ^{8,9}		
SF	Self-flanged trim	PPA102S	<Bluetooth> Bluetooth Powerpack (Consult factory for installation location)

NOTES:

- Shipped separately.
- Available with 16L, 25L and 38L only.
- Must be ordered with ED560 or MU050 driver.
- Only available up to 38W.
- 38L model is exempt.
- 0-10V dimming as standard.
- LED driver and EM (if selected) will be included.
- This limited warranty covers electrical parts only and does not apply to labor, equipment lease, or defect from improper installation or operation.
- Available with 0-10V dimming only. (Up to 50W).
- Contact the factory for other emergency battery backup options.
- Must specify voltage, not available with 347V.
- There is a 33% lumen decrease.
- Provided with a remote driver box.
- EMI15 can't be used with 11L or lower wattage, and EMI25 can't be used with 16L or lower wattage.
- Contact the factory to check for a qualifying LED driver.

COMPATIBLE DIMMER SWITCH (TABLE 1)

Model #	Brand	Compatible Dimmer Switch	
DM (0-10V, dim to 1%)	-	<Leviton>	IlumaTech series (IP710-DL)
		<Lutron>	Nova series (NFTV-xx), Diva series (DVTV-xx)
DM (120Vac for Triac, ELV)	-	<Lutron>	S-603PG, DVCL-153P, DV-600P, TGCL-153P, S600P, DVCLV-303P, SELV-300P, TG-600P, LG-600P, CT-103P, MAELV-600, FAELV-500
		<Leviton>	IPI06-1LZ, 6631-2, VPE06, 6683-IW, 6161, 6633-P, IPE04
		<Cooper>	DLC03P, SLC03P, DAL06P
		<Lightolier>	ZP260QEW
ED560	eldoLED DUALdrive	<Lunatone>	SS-LUNAT PS2 30mA SS-LUNAT Touch or BT SS-LUNAT Comm
LDE1	Lutron Hi-lume 1% EcoSystem	<Lutron>	PowPak Dimming Modules: RMJ-ECO32-DV-B, FCJ/FCJS-ECO Energi Savr Node (120V only): QSN-1ECO-S, QSN-2ECO-S GRAFIK Eye QS/Homeworks QS control unit (120V only): QSGRJ- E(wireless) QSGR- E Quantum Hub (120V only): QP2- _2C/4C/6C/8C Homeworks QS/myRoom Plus power module (120V only): LQSE-2ECO-D

