

## LAD6A

Project Name:

Type:

**APPLICATION**

6" Horizontal architectural frame-in is design for high quality application with lens. Ideal for commercial, retail, conference rooms and hospital where architectural LED downlight fixture is required.

**FEATURES:**

- Heavy gauge die formed galvanized steel mounting frame trim clips to mount open conical shape reflector.
- Vertically adjustable mounting brackets that use conduit or C channel (please see drawing for recommended C channel size on the next page). Provides 3-3/4" total adjustment.
- C channel is optional, not included as std.
- Post installation adjustment possible from above or below the ceiling.
- Maximum 1-1/2" ceiling thickness.
- Reflectors are optically designed to maximize lumen output and to provide superior glare control.
- Non-insulated ceilings or where insulation can be kept 3" from all side of housing.

**JUNCTION BOX:**

- Galvanized steel junction box with seven 1/2" knockouts, four pryouts, and snap on cover.
- Electrical connections are made through a single junction box door.
- Access to junction box from below ceiling after removal of reflector for easy maintenance.

**LED:**

- CREE LED technology.
- 50,000 hours.
- 4000K color temperature standard.
- 16W, 25W, 38W, 50W, 70W, 100W LED.
- Color Rendering Index: > 90
- Projected L70 hours: 60,000

**ELECTRICAL:**

- Input voltage: 120-277V
- 3 in 1 dimming: Triac (120V only), 0-10V (dim to 1%, 120-277V), ELV (120V only).
- Operating Temperature: -4°F (-20°C) ~ 104°F (40°C)
- Thermal protection.
- Surge protection (3kV line to line, 6kV line to earth).
- Protections: Output open load, over-current and short-circuit(hiccup), and over-temperature with auto recovery.
- Conducted and radiated EMI: Compliant with FCC CFR Title 47 Part 15 Class B (120 Vac)/ Class A (277 Vac) and EN55015 (CISPR 15) at 220/230/240 Vac.
- <ELCU-200>
- Guarantees emergency lighting remains ON or is turned on when power to the control device is lost.
- Interfaces with fire alarm panel or security system.
- "Watchdog" feature allows emergency loads to be controlled in tandem with normal power loads.
- UL listed for use in emergency circuits.

**LISTING:**

- ROHS.
- UL/CUL listed for damp locations with covered ceiling.
- UL/CUL wet location listed with "W" lens only.
- Listed to UL 1598 and UL 8750.
- Minimum 75°C supply conductors.
- CSA certified to US.
- Energy Star certified. <sup>5</sup>
- 5 years limited warranty.
- 10 years limited warranty (optional). <sup>8, 9</sup>
- ARRA compliant (optional).
- BAA compliant (optional).

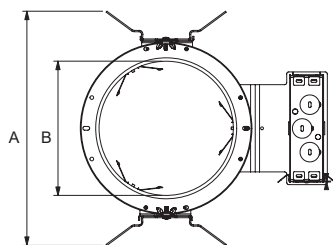
**Dimensions**

A: 10-7/8" (276)  
B: 6-1/4" Dia. (158)

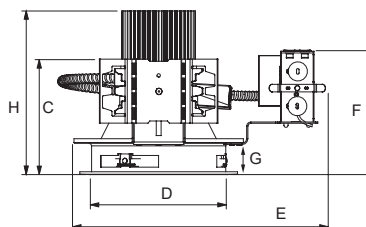
**Dimensions (16W, 25W, 38W, 50W)**

C: 5-3/8" (136)  
D: 6-5/16" Dia. (160)  
E: 11-7/8" (302)  
F: 5-3/4" (146)  
G: 1-1/2" (38)  
H: 7-11/16" (195.6)

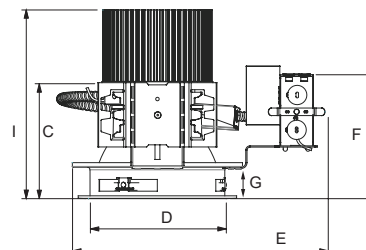
**Dimensions (70W, 100W)**

C: 5-3/8" (136)  
D: 6-5/16" Dia. (160)  
E: 11-7/8" (302)  
F: 5-3/4" (146)  
G: 1-1/2" (38)  
I: 8-7/8" (224.6)

**Recommended C Channel Bar**  
part# CHB24 (optional)

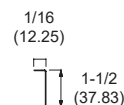
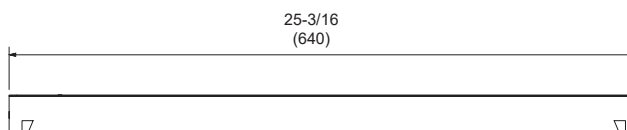

All dimensions are in inches.  
Drawings are for dimensional detail information only.

# LAD6A

## ORDERING INFORMATION

EXAMPLE: LAD6A-25L-40K-UNV-EMI15-WW-W-O60

MODEL		LED				COLOR TEMP.		VOLTAGE		LED DRIVER	
LAD6A	6" Architectural Frame	11L	11W LED <sup>6</sup>	<u>Lumen Output</u>	<u>Lumen Efficiency</u>	-27K	2700K	UNV 347	120-277V 347V <sup>4</sup>	DM	- Triac (120V Only)
		16L	16W LED	1000 lm	90.9 lm/W	-30K	3000K				- 0-10V(dim to 1%, 120-277V)
		25L	25W LED	1458 lm	90.6 lm/W	-35K	3500K				- ELV (120-277V)
		38L	38W LED	2302 lm	92.1 lm/W	-40K	4000K (Std.)				0-10V dim to 1%
		50L	50W LED	3035 lm	82 lm/W	-50K	5000K				5%, Lutron (Ecosystem) <sup>2</sup>
		70L	70W LED	3904 lm	80.8 lm/W	-275K	Tunable white 2700-5000K (Max. 50W) <sup>3</sup>				1%, Lutron (Soft Fade to Black, Ecosystem) <sup>2</sup>
		100L	100W LED	5920 lm	84.2 lm/W						0-10V dim to 1% for -275K (Tunable White)
											eldoLED LightShape DALI dim to dark, 0.1% ~ 100%
											eldoLED POWERdrive DMX/RDM Full-color, 0.1% ~ 100%
											SDXX XX% / 100% Bi-Level Step dim (Specify XX : 10%~70%) <sup>13</sup>
											PHDL Philips Xitanium Sensor-Ready, Dali 5%~100% dim

EM <sup>10, 11, 14</sup>		REFLECTOR		TRIM RING		LENS		OPTIC	
<b>EMI8</b>	1296 LUMEN EM Battery Backup	<b>WW</b>	White Reflector w/ White Plastic Ring	<b>(Blank)</b> <b>BK</b>	White Trim Ring Black Trim Ring	<b>(Blank)</b> <b>W</b>	Dry / Damp location White Smooth Splay w/ Frosted Lens (Wet Location) <sup>12</sup>	<b>O20</b>	Narrow
<b>EMI15</b>	2430 LUMEN EM Battery Backup	<b>CW</b>	Clear Reflector w/ White Plastic Ring					<b>O40</b>	Medium
<b>EMI25 INT</b>	4050 LUMEN EM Battery Backup EM Pilot Located on Reflector	<b>PLW</b>	Platinum Haze Reflector w/ White Plastic Ring					<b>O60</b> <b>WA</b>	Wide (Std.) Wall Wash

OPTIONS		LIGHTING CONTROL SYSTEM	
<b>ARRA</b>	Assembled in USA for Buy American Act	<b>VRF</b> <b>FCJS0</b> <b>FCJSE</b> <b>FCJS0EM</b> <b>FCJSEEM</b>	<Lutron Vive System Enabled>
<b>BAA</b>	BAA(Buy American Act) and BABA(Build America Buy America) compliant		Vive Integral fixture control (RF only, for Lutron EcoSystem drivers)
<b>ELCU-200</b>	Fail-to-on Emergency lighting, UL924 <sup>1</sup>		FCJS-010, Vive Attached fixture control (RF only for 0-10V drivers)
<b>GTD</b>	Bodine Generator Transfer Device		FCJS-ECO, Vive Attached fixture control (RF only for Lutron EcoSystem drivers)
<b>GTD10DIM</b>	Bodine Generator Transfer Device (0-10VDC Dimmer Override)		FCJS-010-EM, UL 924 Emergency (Must be ordered with FCJS-010)
<b>CHB24</b>	C-Channel Bar	<b>PPA102S</b>	FCJS-ECO-EM, UL 924 Emergency (Must be ordered with FCJS-ECO)
<b>FRAME</b>	Rough-in frame pre-ship request <sup>7</sup>		<Bluetooth>
<b>O10W</b>	Optional 10 Years Limited Warranty <sup>8,9</sup>		Bluetooth Powerpack (Consult factory for installation location)
<b>SF</b>	Self-flanged trim		

### NOTES:

1. Shipped separately.
2. Available with 16L, 25L and 38L only.
3. Must be ordered with ED560 or MU050 driver.
4. Only available up to 38W.
5. 38L model is exempt.
6. 0-10V dimming as standard.
7. LED driver and EM (if selected) will be included.
8. This limited warranty covers electrical parts only and does not apply to labor, equipment lease, or defect from improper installation or operation.
9. Available with 0-10V dimming only. (Up to 50W)
10. Contact factory for other emergency battery backup options.
11. Must specify voltage, not available with 347V, 480V.
12. There is a 33% lumen decrease.
13. Provided with a remote driver box.
14. EMI15 cannot be used with 11L or Lower Wattage, and EMI25 cannot be used with 16L or Lower Wattage.

# LAD6A

COMPATIBLE DIMMER SWITCH (TABLE 1)

Model #	Brand	Compatible Dimmer Switch	
DM (0-10V, dim to 1%)	-	<Leviton>	IlumaTech series (IP710-DL)
		<Lutron>	Nova series (NFTV-xx), Diva series (DVTV-xx)
DM (120Vac for Triac, ELV)	-	<Lutron>	S-603PG, DVCL-153P, DV-600P, TGCL-153P, S600P, DVELV-303P, SELV-300P, TG-600P, LG-600P, CT-103P, MAELV-600, FAELV-500
		<Leviton>	IPI06-1LZ, 6631-2, VPE06, 6683-IW, 6161, 6633-P, IPE04
		<Cooper>	DLC03P, SLC03P, DAL06P
		<Lightolier>	ZP260QEW
ED560	eldoLED DUALdrive	<Lunatone>	SS-LUNAT PS2 30mA SS-LUNAT Touch or BT SS-LUNAT Comm
LDE1	Lutron Hi-lume 1% EcoSystem	<Lutron>	PowPak Dimming Modules: RMJ-ECO32-DV-B, FCJ/FCJS-ECO Energi Savr Node (120V only): QSN-1ECO-S, QSN-2ECO-S GRAFIK Eye QS/Homeworks QS control unit (120V only): QSGRJ-_E(wireless) QSGR-_E Quantum Hub (120V only): QP2-_2C/4C/6C/8C Homeworks QS/myRoom Plus power module (120V only): LQSE-2ECO-D
LDE5	Lutron 5-Series EcoSystem		

BEAM ANGLE (OPTIC) TABLE

Wattage	LAD4-CW			LAD6-CW			LAD8-CW		
	O20	O40	O60	O20	O40	O60	O20	O40	O60
11W	23.1°	42.8°	57.8°	21.6°	36.8°	56.6°			
16W	23.1°	42.8°	57.8°	21.6°	36.8°	56.6°	23.1°	39°	58.2°
25W	25°	44.3°	58.9°	23.8°	39.1°	58.1°	24.7°	40.5°	59.1°
38W	34.8°	53.6°	60.2°	31.9°	48.8°	59.9°	33.1°	53.9°	61.4°
50W	34.3°	51.2°	59.7°	31.8°	47.4°	58.7°	33.4°	50.1°	61.7°
Wattage	LAD4-WW			LAD6-WW			LAD8-WW		
	O20	O40	O60	O20	O40	O60	O20	O40	O60
11W	22.9°	40.8°	52.7°	22.7°	40.7°	55.2°			
16W	22.9°	40.8°	52.7°	22.7°	40.7°	55.2°	22.5°	39.2°	57.8°
25W	24.3°	41.6°	53.5°	24.6°	41.5°	56.3°	24.5°	40.3°	58.7°
38W	34.3°	48.5°	55.6°	34.1°	50.8°	58°	33.5°	49.2°	62.5°
50W	33.7°	46.9°	55.3°	33.6°	48.6°	58°	33.7°	47.3°	63.3°
Wattage	LAD4-PLW			LAD6-PLW			LAD8-PLW		
	O20	O40	O60	O20	O40	O60	O20	O40	O60
11W	22.7°	42.1°	54.9°	22.2°	40.4°	54.6°			
16W	22.7°	42.1°	54.9°	22.2°	40.4°	54.6°	23°	39.3°	57.7°
25W	24.7°	43.8°	55.5°	24.6°	42°	55.3°	24.5°	40.6°	58.5°
38W	35.6°	51.9°	58°	34°	49°	58°	33.3°	50.1°	60.7°
50W	34.9°	49.3°	57.5°	33.3°	48.5°	57.4°	33.6°	47.4°	61.3°

